

ViewSonic®

N3250w LCD TV Display

- User Guide

- Guide de l'utilisateur

- Guía del usuario



ViewSonic®

Contents

Product Registration.....	2
For Your Records.....	2
Important Product Safety Instructions.....	3
Antenna Installation Instructions.....	4
Cleaning the LCD Display.....	4

Getting Started

Package Contents.....	5
Front View of the Product.....	6
Rear View of the Product.....	7
Remote Control.....	8
Installation.....	19
Basic Operation.....	27

OSD Functions

Source Input-TV, AV, S-Video, YCbCr Mode.....	28
Source Input-VGA, HDMI, YPbPr Mode.....	46

Other Information

Specifications.....	49
Troubleshooting.....	50
Customer Support.....	51
Limited Warranty.....	52

Appendix

Safety Guidelines.....	53
Compliance Information for U.S.A.....	54

Copyright © ViewSonic Corporation, 2005. All rights reserved.

ViewSonic, the three birds logo, OnView, ViewMatch, and ViewMeter are registered trademarks of ViewSonic Corporation.

Disclaimer: ViewSonic Corporation shall not be liable for technical or editorial errors or omissions contained herein; nor for incidental or consequential damages resulting from furnishing this material, or the performance or use of this product.

In the interest of continuing product improvement, ViewSonic Corporation reserves the right to change product specifications without notice. Information in this document may change without notice.

No part of this document may be copied, reproduced, or transmitted by any means, for any purpose without prior written permission from ViewSonic Corporation.

Product Registration

To meet your future needs, and to receive any additional product information as it becomes available, please register your product on the Internet at: www.viewsonic.com.

For Your Records

Product Name:	ViewSonic N3250w
Model Number:	VS10769-1M
Serial Number:	_____
Purchase Date:	_____

Product disposal at end of product life

ViewSonic is concerned about the preservation of our environment. Please dispose of this product properly at the end of its useful life. Your local waste disposal company may provide information about proper disposal.

IMPORTANT PRODUCT SAFETY INSTRUCTIONS

ATTENTION:

Follow and obey all warnings and instructions marked on your product and its operating instructions. For your safety, please read all the safety and operating instructions before you operate this product follow its operating and keep this user guide for future reference.

INSTALLATION

1. Grounding or Polarization

Your product may be equipped with a polarized alternating-current line plug (a plug having one blade wider than the other). This plug will fit into the power outlet only one way. This is a safety feature. If you are unable to insert the plug fully into the outlet, try reversing the plug. If the plug should still fail to fit, contact your electrician to replace your obsolete outlet. Do not defeat the safety purpose of the polarized plug.

2. Overloading

Do not overload wall outlets, extension cords, or integral convenience receptacles as this can result in a risk of fire or electric shock.

3. Power Cord Protection

Power supply cords should be routed so that they are not likely to be walked on or pinched by items placed upon or against them, paying particular attention to cords at plugs, convenience receptacles, and the point where they exit from the product.

4. Ventilation

Slots and openings around the cabinet are provided for ventilation.

To ensure reliable operation of the product and to protect it from overheating, these openings must not be blocked or covered.

- Do not block the openings by placing the product on a bed, sofa, rug or other similar surface.
- Do not place the product in a built-in installation such as a bookcase or rack unless proper ventilation is provided or the manufacturer's instructions have been adhered to.

5. Other Notices

- Avoid exposure the N3250w to direct sunlight or high temperature.
- Avoid exposure the N3250w to moisture or high humidity.
- Do not attempt repair yourself. Your warranty does not cover repair or attempted repair by anyone not authorized by ViewSonic.
- If your N3250w will not be used for a long period of time, unplug the power cord and remove the batteries from the remote control.

6. Precautions

Sit at least 32" from your LCD display.

Avoid touching the screen. Skin oils are difficult to remove.

Never remove the rear cover. Your LCD display contains high-voltage parts. You may be seriously injured if you touch them.

- Avoid exposing your LCD display to direct sunlight or another heat source. Orient your LCD display away from direct sunlight to reduce glare.
- Always handle your LCD display with care when moving it.
- Place your LCD display in a well-ventilated area. Do not place anything on your LCD display that prevents heat dissipation.
- Ensure the area around the LCD display is clean and free of moisture.
- Do not place heavy objects on the LCD display, video cable, or power cord.
- If smoke, abnormal noise, or strange odor is present, immediately switch the LCD display off and call your dealer or ViewSonic. It is dangerous to continue using the LCD display.

ANTENNA INSTALLATION INSTRUCTIONS

1. Outdoor Antenna Grounding

If an outside antenna or cable system is connected to the product be sure the antenna or cable system is grounded so as to provide some protection against voltage surges and built-up static charges, Article 810 of the National Electrical Code, ANSI/NFPA 70, provides information with regard to proper grounding of the mast and supporting structure, grounding of the lead-in wire to an antenna discharge unit, connection to grounding electrodes, and requirements for the grounding electrode.

2. Lightning

For added protection for this product during a lightning storm, or when it is left unattended and unused for long periods of time, unplug it from the wall outlet and disconnect the antenna or cable system. This will prevent damage to the product due to lightning and power-line surges. Do not disconnect the antenna or the power cord during a heavy storm lightning may strike while you are holding the cable cord, causing serious injury; turn off you LCD and wait for the wether to improve.

3. Power Lines

An outside antenna system should not be located in the vicinity of overhead power lines or other electric light or power circuits, or where it can fall into such power lines or circuits, When installing an outside antenna system, extreme care should be taken to keep from touching such power lines or circuits as contact with them might be fatal.

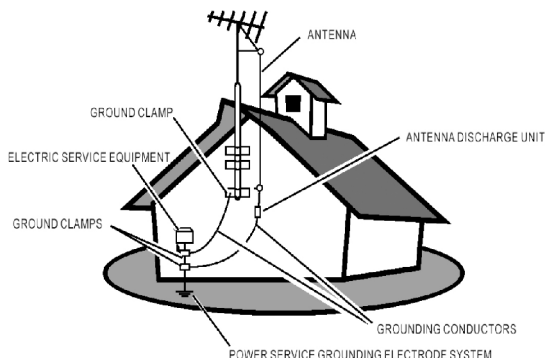

Cleaning the LCD Display

- Make sure the LCD Display is turned off.
- Never spray or pour any liquid directly onto the screen or case.

To clean the screen:

- 1 Wipe the screen with a clean, soft, lint-free cloth. This removes dust and other particles.
- 2 If still not clean, apply a small amount of non-ammonia, non-alcohol based glass cleaner onto a clean, soft, lint-free cloth, and wipe the screen.

To clean the case:

- 1 Use a soft, dry cloth.
- 2 If still not clean, apply a small amount of a non-ammonia, non-alcohol based, mild non-abrasive detergent onto a clean, soft, lint-free cloth, then wipe the surface.

Disclaimer

ViewSonic® does not recommend the use of any ammonia or alcohol-based cleaners on the LCD display screen or case. Some chemical cleaners have been reported to damage the screen and/or case of the LCD display. ViewSonic will not be liable for damage resulting from use of any ammonia or alcohol-based cleaners.

Getting Started

Congratulations on your purchase of a ViewSonic® LCD TV display. **Important!** Save the original box and all packing material for future shipping needs.

Package Contents

Your LCD TV display package includes:

- LCD TV Display
- RCA A/V Cable
- VGA Cable
- Quick Start Guide
- Power Cable
- Universal Remote Control with batteries
- ViewSonic User Guide
- Note: contact VIEWSONIC



Front View of the Product



- 1 Volume Down**
Decrease volume or adjust a highlighted control decreasingly while in OSD menu.
- 2 Volume Up**
Increase volume or adjust a highlighted control increasingly while in OSD menu.
- 3 MENU**
Turn OSD menu ON/OFF.
- 4 CH Down**
Channel down/ Scroll down.
- 5 CH Up**
Channel up/ Scroll up.
- 6 ENTER**
Confirm selection.
- 7 Power button**
- 8 Remote control receiver**

Rear View of the Product

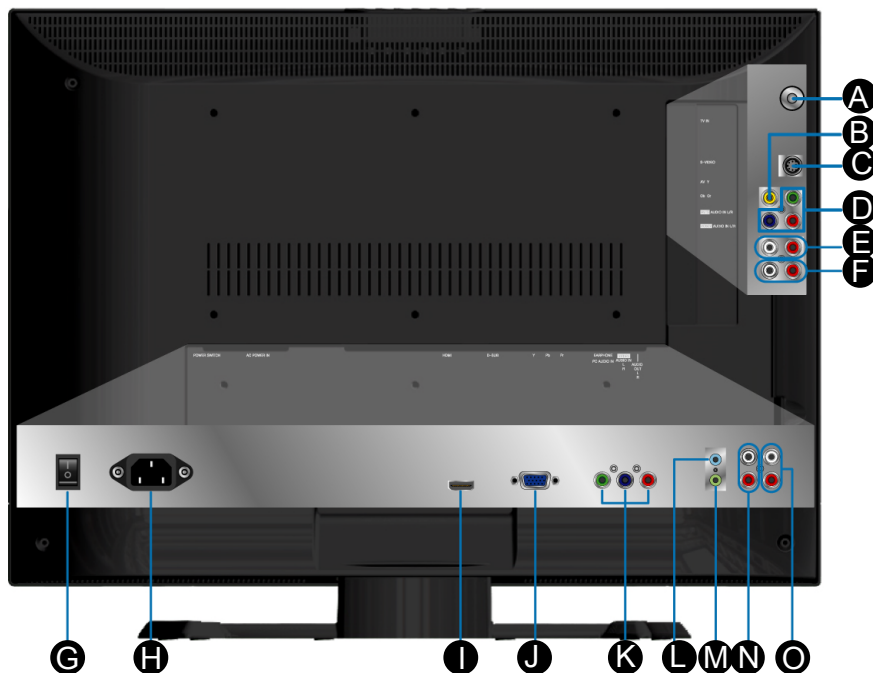

- A TV signal input**
Connect to the antenna or cable service.
- B AV Video input**
Connect the external video devices such as VCR, DVD and video game into this jack.
- C S-Video input**
Connect the external video device such as VCR, DVD and video game into this jack.
- D YCbCr signal input**
Connect the external video device with component output to these jacks.
- E AV/ S-Video signal Audio input (left/right)**
Connect the external audio into this jack.
- F YCbCr signal Audio input (left/right)**
Connect the external audio into this jack.
- G AC power switch (Default = ON)**
- H Power (AC input)**
Using cable provided, connect to a power source.
- I HDMI signal input**
- J VGA signal input**
- K YPbPr signal input**
Connect the external video devices with progressive component output to these jacks.
- L Earphone output (light blue)**
- M PC Audio input (light green)**
- N YPbPr signal Audio input (left/right)**
Connect the external audio into this jack.
- O Audio output**
Connect this port to your external speaker.

Remote Control

E
N
G
L
I
S
H



Remote control button function as follow

A	Source button	Select Input Source
B	*PIP/POP button (Guide)	Activate PIP or POP feature (Activate Guide-WMA only)
C	*SLEEP button	Set timer to turn off TV
D	CC button (◀ Back)	Close Caption (Back button-WMA only)
E	Volume ▲ / Volume ▼	Adjust Volume
F	MUTE button	Mute On/Off
G	POWER button	Power ON/OFF
H	Device buttons	Select desire device
I	*PIP sub-buttons	P. Source: change PIP source Swap: Change PIP to Main CH+: Change channel CH-: Change channel
J	0~100+ number button	Input channel number
K	*WIDE button	Change Aspect Ratio
L	UP/DOWN/LEFT/ RIGHT/ ENTER button	UP/DOWN for OSD function select and LEFT/ RIGHT for function adjust ●VOL- ◀ and VOL+ ▶ button=adjust the volume when there is no OSD menu display. CH- ▼ and CH+ ▲ = change the channel on TV mode when there is no OSD menu display (For certain models)
M	Menu button	Display menu, hold for 2~3 seconds to exit OSD menu.
N	Channel ▼ / Channel ▲	Change channel for TV only
O	**Control buttons	Play/ Stop/ Pause/ Record/ Forward/ Rewind
P	***WMA buttons (MTS/AAP)	Shortcut buttons for: Videos, Music, Pictures and Radio Menu

Note:

* This feature may not be supported under all models.

** For use on other device.

*** WMA adapters sold separately. Contact View Sonic for details.

Key "Defaults"

The 'default' out of box setting enables the Remote to control a predetermine TV, DVD, STB, VCR, VPB, WMA and AUD.

- Depending on Device desire the following model will be active.

Device	Default Setting
TV	ViewSonic
DVD	Samsung
STB	RCA
VCR	Sony
VPB	ViewSonic
WMA	ViewSonic WMA-100
AUD	Sony

Note: Multiple pre-programmed codes are available for some devices; if default setting does not function, see pre-programmed table for additional codes.

Resetting Remote

- To reset remote and access default settings press and hold desire device button for roughly six seconds and enter three digit reset code **000**.
- Replace batteries if remote control keys are not functioning properly, this is a normal behavior that indicates batteries are low.

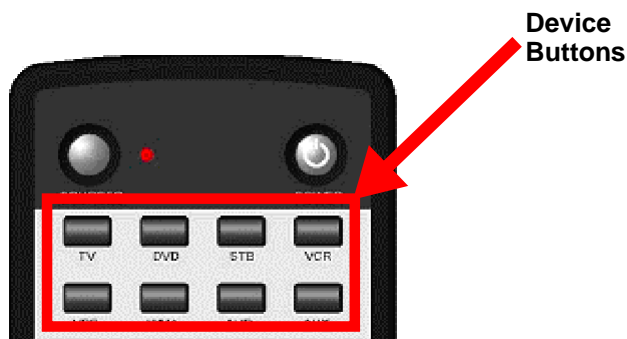

Basic Setup

- 1 Power on the A/V component you wish to setup, so that you can test codes by sending power off commands.
- 2 Refer to the Pre-programmed code tables on pages 2-3 and write down the code number listed.
- 3 Press and hold the button for the desired device for approximately six seconds. The top LED will turn on, enter pre-programmed code. LED will blink to indicate pre-programmed code was captured correctly.

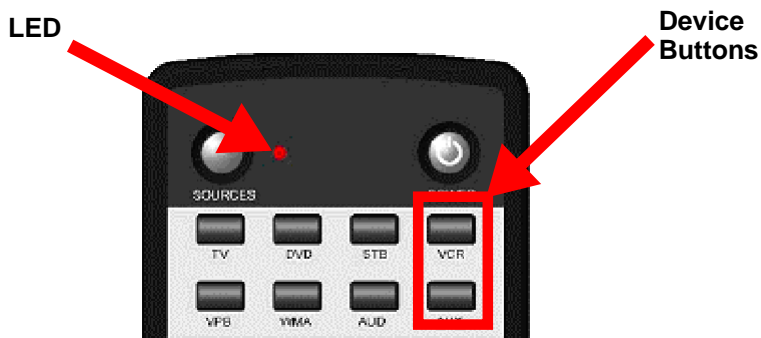

Pre-Programmed Code Notes

Record the three digit codes for your device here:

TV	_____	VPB	_____
DVD	_____	WMA	_____
STB	_____	AUD	_____
VCR	_____	AUX	_____

AUX Key Setup

The AUX key is used to operate a second TV, DVD, STB, VCR, VPB, WMA, and AUD. A fourth digit is necessary to identify the type of device the key will control.



TV = 1	VPB = 5
DVD = 2	WMA = 6
STB = 3	AUD = 7
VCR = 4	

For example, to control a Sony DVD player with a code of 027 under the AUX key a 2 must be added in the beginning of the pre-programmed code making it 2027. If user wants to control a Philips STB with a 006 code under the AUX key a 3 must be added in the beginning of the pre-programmed code making it 3006.

To enter the pre-programmed code press and hold the AUX button for approximately six seconds. The top LED will turn on, enter the pre-programmed code with the first digit to indicate the type of device. LED will blink to indicate pre-programmed code was captured correctly.



Pre-Programmed Code Tables

ViewSonic LCD TV's and Plasmas

BRAND	CODE
N1700W	001
N1300	002
N1500	003
N1750W	004
N2010	005
N2010-E	006
N2700W	007
N2750W	008
N3020W	009
N3200W	010
N3200W-E	011
VPW4255	012
VPW5500	012
N2000	014
N3000W	015

DVD Players-1

BRAND	CODE
Aiwa	001, 033, 051, 118
Aiba	002, 037
Apex	046, 059, 060, 062, 063, 084, 085, 086
Audiovox	119
Blaupunkt	104, 123
Bose	113, 117
Broksonic	052
Bush	003
Clarion	097
Classic	098
CyberHome	004, 005
Daewoo	006, 124, 125
Dansai	007
Denon	034, 120, 140, 141
Emerson	099, 100
Fisher	101, 121
Funai	100, 114
GE	064, 102, 146
Go Video	055, 057
Goodmans	038
GPX	103

DVD Players-2

Grundig	008, 009
Harman Kardon	116
Hitachi	010, 054, 115
Irradio	137
JVC	011, 039, 066, 069, 070, 071, 072
Kenwood	031, 142, 145
Koss	138
LG	012, 040, 041
Magnavox	077, 091
Marantz	130
Memorex	132
Mintek	104
Mitsubishi	133, 134, 135, 136
Mustek	013, 035
NAD	012, 099, 126
Nakamichi	105
Norcet	106, 107
Onkyo	127, 131
Oritron	108
Panasonic	014, 015, 016, 017, 032, 067, 092, 093
Phillips	018, 019, 061, 068, 078, 079, 080, 096
Pioneer	020, 083, 088
Proscan	064, 144
Qwestar	108
RCA	064, 081, 094
Sampo	109
Samsung	000, 021, 042, 047, 049, 065, 089
Sansui	111
Sanyo	023, 036, 053, 110
Scott	024
SEG	025, 043
Sharp	026, 043
Sherwood	112
Sony	027, 028, 044, 074, 075, 090, 095
Sylvania	058, 100, 122
Techwood	128
Thomson	022
Toshiba	029, 045, 048, 050, 076, 082
Yamaha	030, 092, 129, 143
Zenith	056, 139

STB - Set Top Box

BRAND	CODE
Akai	019
Alba	005, 006, 007
Allsat	019
Alphastar	057
Amstrad	001
Ankaro	012
Anttron	005
Apollo	005
Armastrong	010
Asat	019
Astra	010, 013
Astro	007, 008, 012, 015
AudioTon	007
Best	012
Blaupunkt	015
Brain Wave	016
BSkyB	001
Bush	006, 017
Chaparral	054
CityCom	006
Clatronic	016
Condor	012
Crown	010
Daeryung	014
Dish Network	038
DNT	014, 019
Drake	056
Echostar	014, 021, 038, 055
Einhell	005, 010
Elta	005, 012
Emme Esse	012, 017
Ep Sat	006
Eurosat	010
Eurosky	010, 012
Eurostar	010
Express Vu	038
Ferguson	006, 017, 025
Finlandia	006
Finlux	006, 013
Fuba	005, 012, 014, 015, 019
Fujitsu	052
Galaxis	012
GE	031, 040, 041
General Instruments	048, 049
GMI	010
Goodmans	006
Granada	013

Grundig	001, 006, 007, 015, 017, 024
Hanseatic	018
Hirschmann	015
Hisawa	016
Hitachi	006, 017, 053
Hughes	053
Huth	010, 016
Intertronic	010
Janeil	052
Johansson	016
JVC	045
Kathrein	015, 019, 026
KR	007
Kreiselmeier	015
Kyostar	005
Lasat	008
Lenco	005
Luxor	013
Macab	025
Manhattan	006, 008, 017
Marantz	019
Mascom	008
Maspro	006, 017
Mediamarkt	010
Medion	012, 018, 021, 022
Metronic	005, 007, 008, 028
Metz	015
Minerva	015
Mitsubishi	006, 015, 030
Morgan's	010, 019
Nikko	010
Nokia	006, 013, 017, 020
Nordmende	005, 006, 008, 025
Novis	016
Octagon	005, 007
Okano	010
Orbitech	005
Otto Versand	015
Pace	001, 006, 015, 017
Palladium	010
Panasonic	001, 006, 017, 032, 034
Panda	006
Philips	006, 011, 017, 019, 023, 029, 058
Phonotrend	006
Predki	016
Proscan	040, 041
Provision	008
Quadral	012

Quelle	015
Radio Shack	048, 049
Radiola	019
Radix	014
RCA	000, 040, 041
Realisitic	044
RFT	019
Saba	008, 017
Sabre	006
Sagem	025
Salora	013
Samsung	005, 035, 057
Satcom	016, 018
SatPartner	005, 007, 008, 016
Schneider	012, 021, 022
Seemann	010, 014
SEG	005, 009, 012, 016, 018
Siemens	015
Skymaster	018, 021, 022, 027
Sony	043, 059
Star Trak	051
Strong	005, 007, 012
STS	050
Sunstar	010
Tandberg	025
Tandy	007
Tantec	006, 017
TechniSat	014
Teco	010
Telasat	018
Telefunken	005, 017
Teleka	007, 010, 014
Telemaster	008
Telesat	018
Televes	006
Thomson	002, 003, 004, 006, 025
Thorn	006, 017
Tonna	006
Toshiba	036, 042
Triax	015
Uniden	046, 047
Unisat	010
Unitor	016
Universum	015
Visiosat	016
Vortec	005
Wewa	006
Womersat	016
Wisi	006, 014, 015
Zehnder	008, 012, 028
Zenith	033, 037, 052

Cable

BRAND	CODE
ABC	006, 067, 069, 105
Archer	072, 073
Cabletime	060
Contec	078
Eastern	079
France Telecom	061
GE	066
Gemini	080, 081
General Instrument	066, 107
Grundig	062
Hamlin	082, 083, 084, 089, 106
Hitachi	066
Jerrold	066, 080, 085, 086, 101, 105, 107
Magnavox	087
Motorola	108
NEC	068
Nokia	063
Panasonic	102, 104
Philips	064, 074, 075, 076, 077, 081, 087, 091, 092, 093
Pioneer	094, 095
Proscan	066
RCA	070, 104, 107
Realistic	072
Sagem	065
Samsung	095
Scientific Atlanta	069, 096, 097, 098
Signature	066
Sprucer	104
Starcom	080, 105
Stargate	080
Tocom	067, 085
United Cable	105
Universal	071, 072, 073
Zenith	103

VCR

BRAND	CODE
Action	102
Admiral	101, 144, 145
Aiko	127
Aiwa	005, 126
Audiovox	122
Bell & Howell	119
Broksonic	059, 105, 120
Calix	122
Canon	124, 125
Capehart	083, 138
Carver	131, 151
CCE	127, 130
Citizen	095, 121, 122, 123, 127
Colortyme	096, 117
Craig	085, 090, 104, 121, 122, 130
Curtis Mathes	077, 079, 114, 117, 121, 124, 125, 150
Daewoo	006, 007, 083, 102, 123, 126, 127, 138
Daytron	083, 102, 138
Denon	088
Dimensia	114, 150
Electrohome	090, 122
Emerson	087, 090, 105, 115, 120, 122, 123, 124, 126, 132, 140
Fisher	089, 104, 119
Fuji	116, 124
Funai	095, 126
Gerrard	126
GE	065, 079, 081, 087, 114, 121, 124, 125, 141, 150
Go Video	054, 056, 071, 072, 074, 079, 081, 085, 086
Goldstar	079, 090, 092, 117, 122
Gradiente	090, 126
Harman Kardon	117, 151
Harwood	130
Hitachi	008, 009, 053, 062, 063, 088, 128, 129, 136, 139, 141
JBL	098

JC Penney	079, 085, 088, 090, 117, 118, 119, 120, 121, 122, 124, 125, 128, 129, 130, 131, 136
Jensen	128, 129, 139
JVC	010, 011, 040, 043, 058, 087, 088, 117, 118, 119, 139, 142
Kenwood	077, 117, 118, 119, 139, 142
KLH	130
Kodak	122, 124
LG	012, 013, 122
Lloyds	077, 095, 104
Loewe	037
Logik	085, 130
LXI	122
Magnasonic	085, 090, 102
Magnovox	069, 085, 124, 125, 131, 135
Marantz	077, 092, 117, 118, 119, 124, 131, 151
Matsushita	124
Memorex	073, 088, 090, 091, 097, 104, 119, 121, 122, 124, 126, 135, 144, 145
MGA	132, 140
MGN	079
Minolta	088, 128, 129, 136
Mitsubishi	014, 066, 068, 090, 128, 129, 132, 140, 142, 152
Montgomery Ward	144, 145
Motorola	124, 144, 145
MTC	085, 121
Multitech	121, 126, 130
NEC	077, 092, 117, 118, 119, 139, 142
Nikko	122
Noblex	121
Olympus	124
Optimus	090, 094, 122, 144, 145
Optonica	133
Orion	087, 090, 105
Panasonic	015, 016, 017, 018, 019, 020, 021, 037, 044, 067, 070, 085, 090, 104, 105, 124, 125, 137

Pentax	077, 088, 128, 129, 136, 141
Philips	022, 023, 024, 025, 026, 027, 076, 110, 111, 124, 131, 133, 151
Pioneer	078, 103, 118, 128, 142, 146
Portland	083, 138
Precision	102
Proscan	114, 150
Proton	085
Quasar	090, 124, 125
Radio Shack	090, 122, 133, 145
Radio Shack/Realistic	119, 121, 122, 124, 125, 126, 133, 144
Radix	122
RCA	048, 051, 078, 079, 088, 114, 115, 121, 124, 128, 129, 136, 141, 148, 149, 150
Realistic	079, 090, 094, 097, 104, 119, 121, 122, 123, 124, 125, 126, 133, 144, 145
Ricoh	143, 147
Runco	135
Saba	038, 039
Samsung	028, 029, 057, 060, 079, 095, 107, 109, 121, 123
Sansui	085, 118, 139, 142
Sanyo	030, 052, 089, 097, 104, 119, 121, 151
Scott	090, 120, 123, 132
Sears	077, 088, 089, 090, 097, 104, 119, 122, 124, 128, 129, 136
Sharp	041, 042, 049, 050, 091, 094, 101, 133, 144, 145
Shintom	085, 116, 129, 130
Signature	144, 145
Signature 2000	097, 101
Singer	085, 124, 130, 143, 147
Sony	000, 001, 002, 003, 004, 045, 075, 080, 082, 084, 098, 099, 116, 134
STS	124, 136
Sylvania	061, 112, 124, 125, 126, 131, 132, 151

Symphonic	077, 095, 104, 126
Tandy	119
Tashiko	122
Tatung	139
Teac	126, 139, 148
Technics	124, 137
Teknika	090, 122, 124, 126
Thomson	031, 032, 035, 036, 038
Tivo	113
Toshiba	033, 034, 046, 047, 100, 102, 104, 106, 123, 128, 132, 140
Totevision	090, 121, 122
Unitec	095
Unitech	121
Vector Research	077, 117, 118, 123
Video Concepts	077, 117, 118, 123, 140
Wards	079, 090, 091, 094, 104, 121, 122, 123, 124, 126, 128, 129, 130, 133, 136, 144, 145, 149,
White Westinghouse	095
XR-1000	124, 126, 130
Yamaha	077, 117, 118, 119, 139
Zenith	055, 064, 090, 093, 116, 135, 143, 147

VPB

BRAND	CODE
Next Vision N4	001
Next Vision N5	002
Next Vision N5-2	006
Next Vision N5-2E	007
Next Vision N6	003
Next Vision HD10	004
Next Vision HD12	005

WMA

BRAND	CODE
WMA100	013

AUD

BRAND	CODE
Aiwa	024, 041, 063
Akai	013
Bose	039
Carver	075
Curtis Mathes	065
Denon	001, 053, 054, 059, 076
Fisher	005, 066, 068, 073
GE	030
Goodmans	013
Gradiente	086
Harman Kardon	002, 025, 052, 070
Hitachi	003, 083
JBL	025
Jensen	085
Jerrold	026, 028
JVC	004, 050, 057
Kenwood	005, 055, 058, 072, 080
Luxman	088
Marantz	042
McIntosh	082
NAD	064
Nakamichi	078
NEC	064
Nikko	087
Onkyo	006, 044, 048, 079
Optimus	065, 071
Panasonic	032, 033, 051, 056, 062, 074, 091
Philips	007, 037, 038, 040
Pioneer	008, 035, 045, 049, 065, 069
Proscan	030
Quasar	074
Radio Shack	071
RCA	029, 030, 031, 034
RCA & Dimensia	019, 020, 021, 022, 023
Roadstar	013
Saisho	013
Samsung	009
Sansui	013, 081
Sanyo	066, 068
Scientific Atlanta	027
Sharp	010, 084
Sherwood	011, 071
Sony	000, 012, 046, 060, 067
Starcom	026
Technics	014, 043, 047, 074

Thomson	015, 016
Toshiba	036
Uher	013
Yamaha	017, 018, 061, 072, 077
Zenith	089

Installation

1. Insert Remote Control Batteries



- 1 Remove the battery cover by pulling then lifting the knob on the cover.
- 2 Insert the batteries, corresponding to the (+) and (-) markings on the battery compartment.
- 3 Reattach the battery cover.



CAUTION

- Only use the specified AA batteries.
- Do not mix new and old batteries. This may result in cracking or leakage, which may pose a risk of fire or lead to personal injury.
- Insert batteries according to (+) and (-) markings. Inserting the batteries incorrectly may result in cracking or leakage, which may pose a risk of fire or lead to personal injury.
- Dispose of the battery in accordance with local laws and regulations.
- Keep the battery away from children and pets.
- When the remote control will not to be used for an extended period, remove the batteries.

2. Connecting with the antenna

Make sure the power is off before installing N3250w.

Connect the LCD TV to TV antenna terminal or CATV box by 75-ohm coaxial cable.

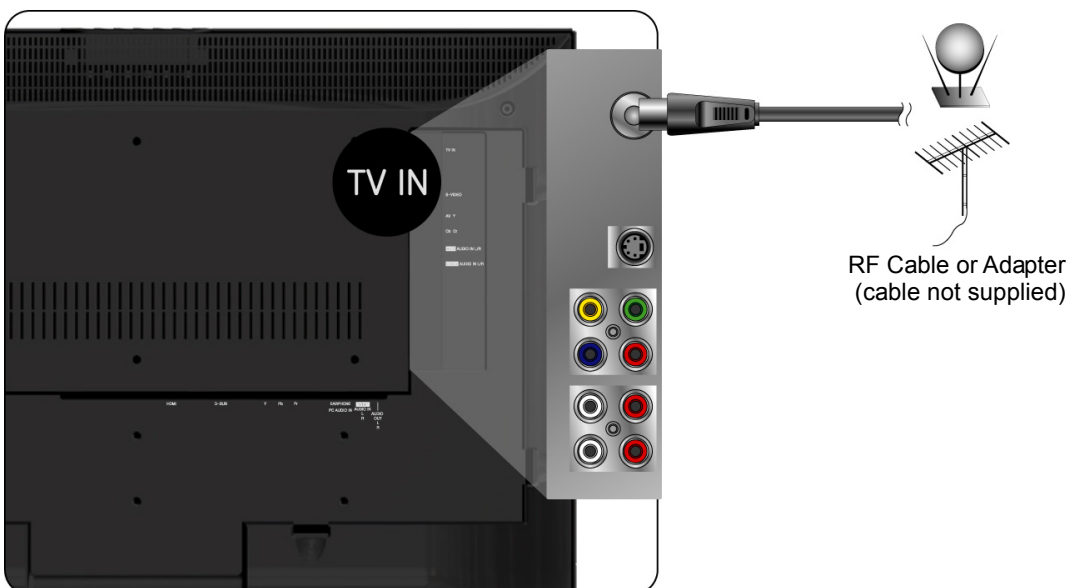

3. Connect Audio Cable

Connect Video/Audio cables from compatible devices into the back panel of N3250w.

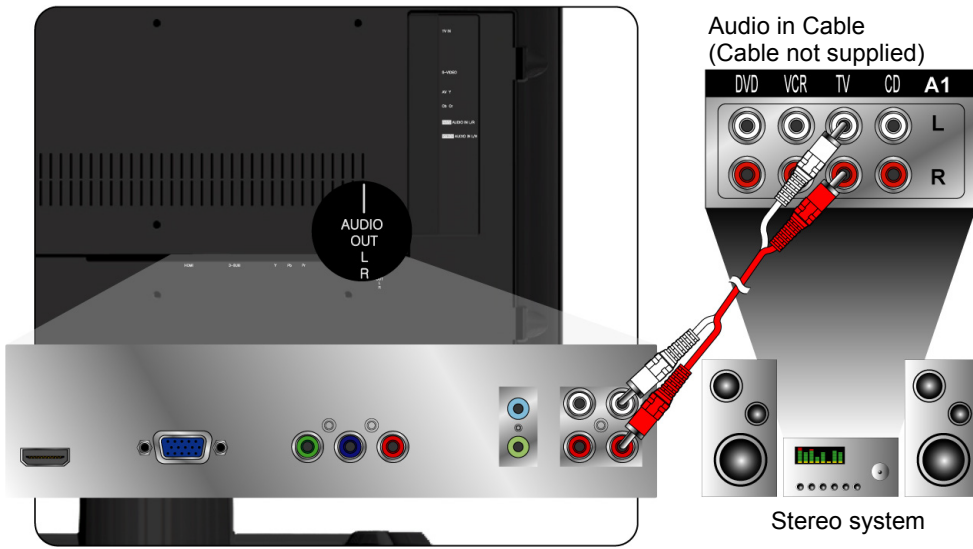

OPTIONAL:

To connect an external amplifier, connect the L/R RCA cable from the TV AUDIO OUT port to the appropriate AUDIO IN port on a compatible amplifier as shown on the right.

4. Connect AV, S-Video, YCbCr, YPbPr, HDMI to Video Devices

Connect Video/Audio cables from compatible devices into the back panel of N3250w.

AV model:

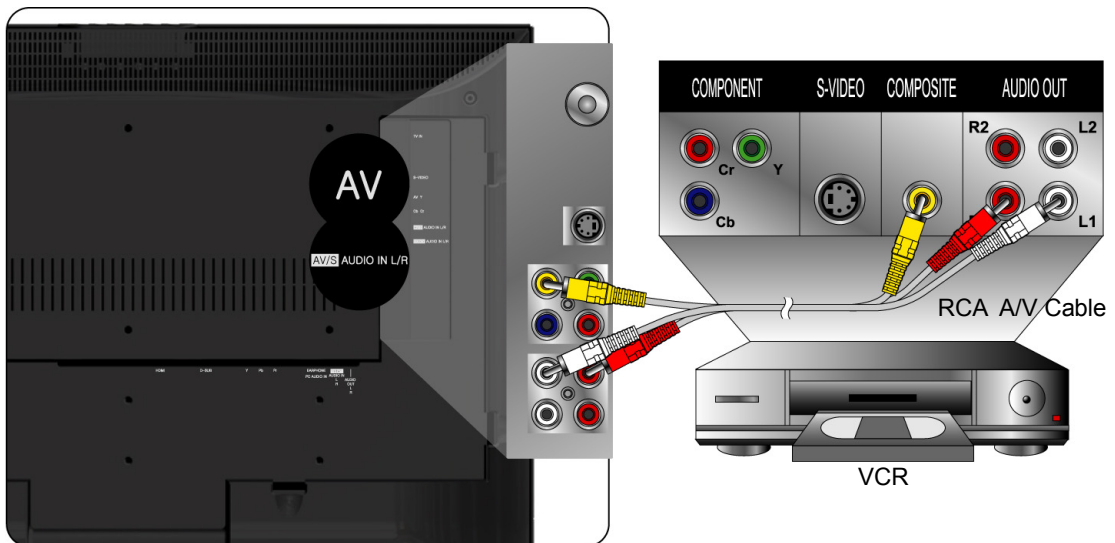

S-Video model:

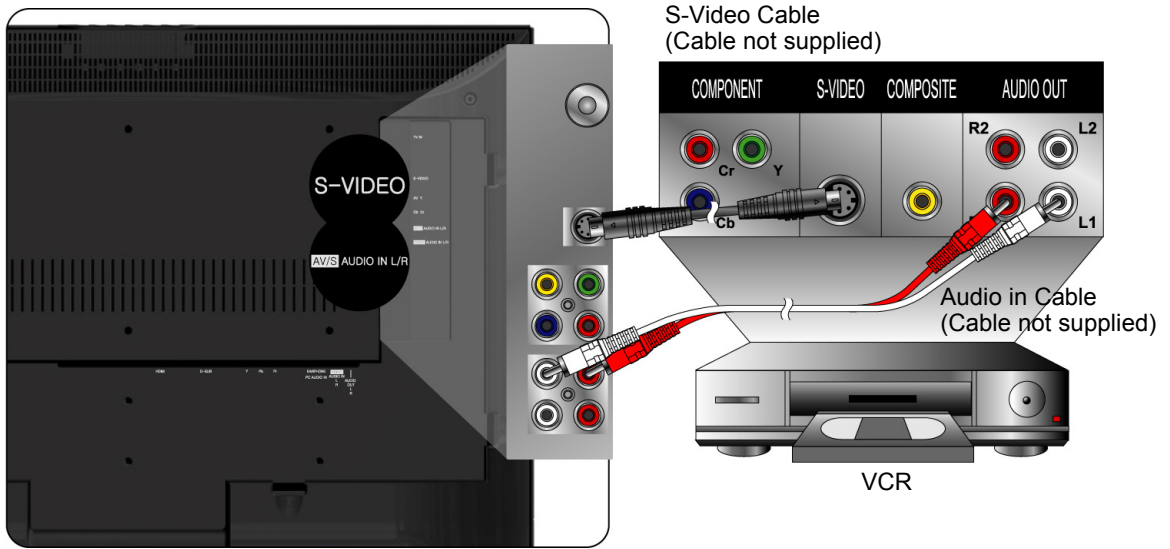

YCbCr model:

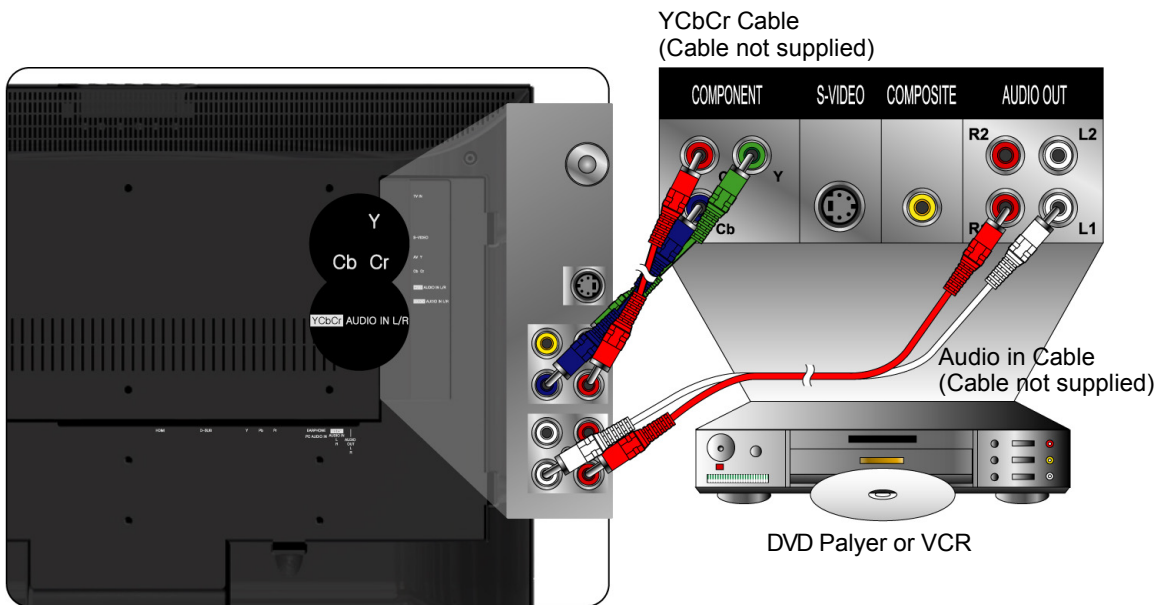

YPbPr model:

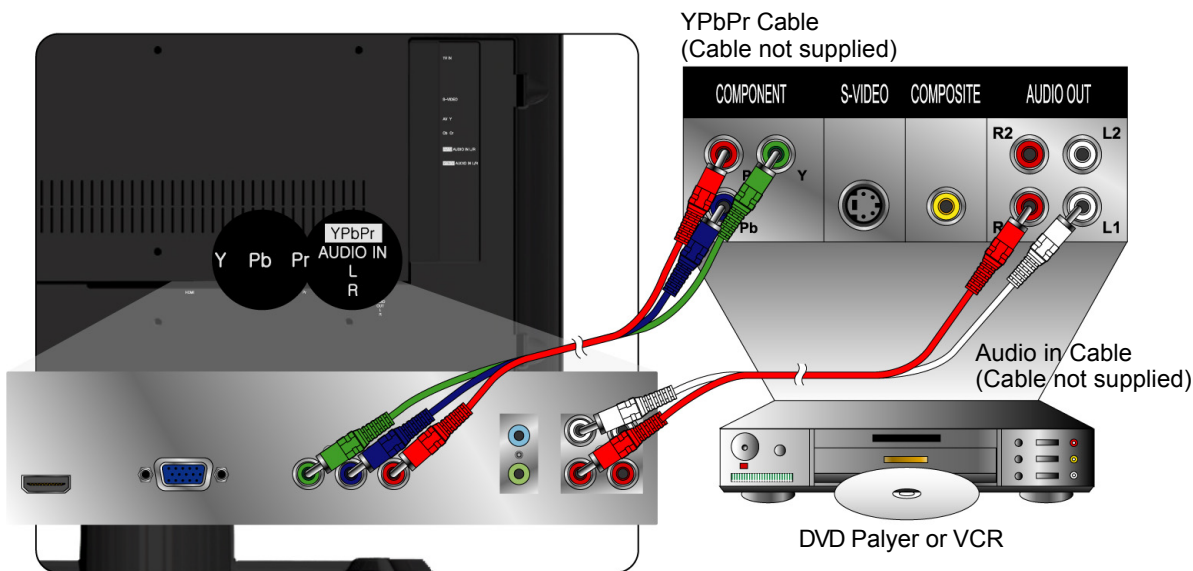

HDMI model:

There are two possible HDMI cable terminals of your DVD player. Please refer to one of the connection that fits for your requirement.

(1) HDMI-DVI cable

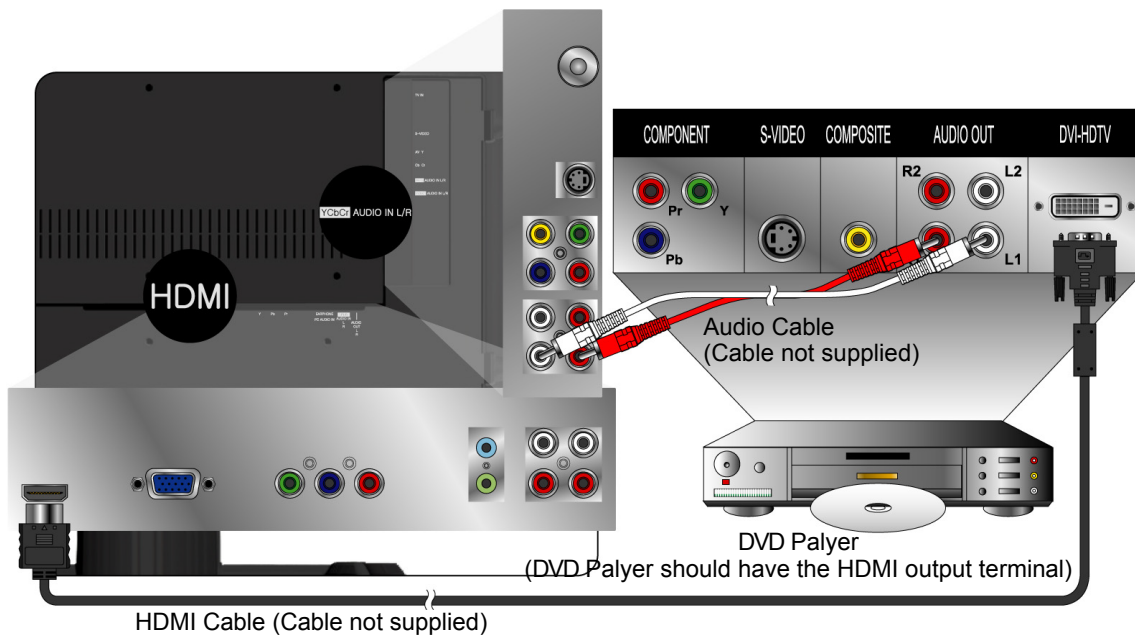

Note: To receive the sound from DVD, please turn on Sound Menu of OSD for selecting HDMI audio to YCbCr. However, the input source should be in in HDMI (see Page 44).

(2) HDMI cable

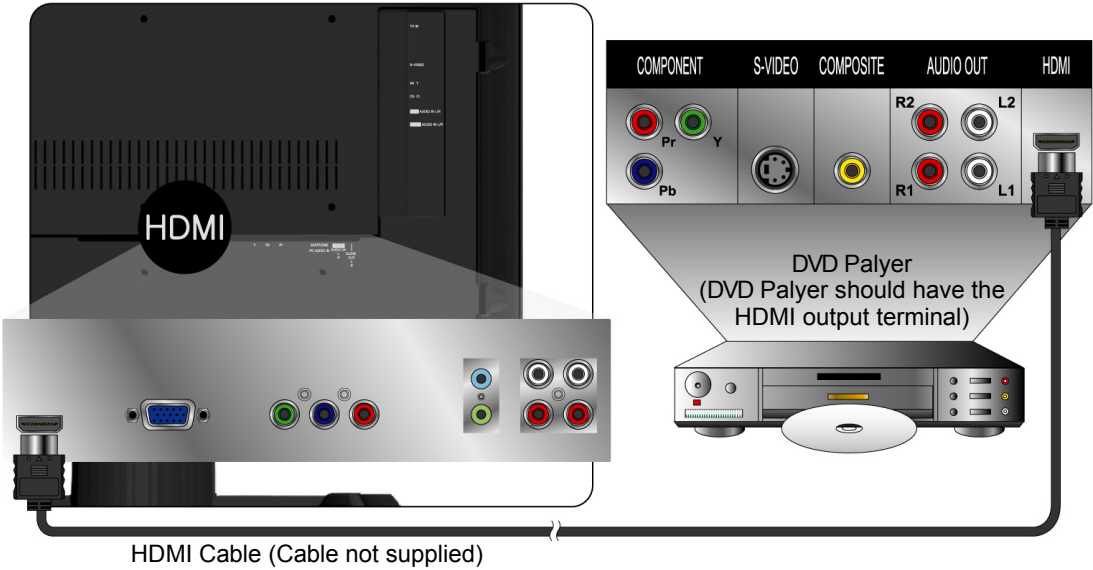

Note: To receive the sound from DVD, please turn on Sound Menu of OSD for selecting HDMI audio to HDMI. However, the input source should be in in HDMI (see Page 44).

5. Connect to the PC

VGA (15pin D-Sub):

Connect the VGA cable from VGA output of PC to the VGA terminal input of N3250w. PC up to 1280 x 1024, or 1360 x 768 is the preferred resolution.

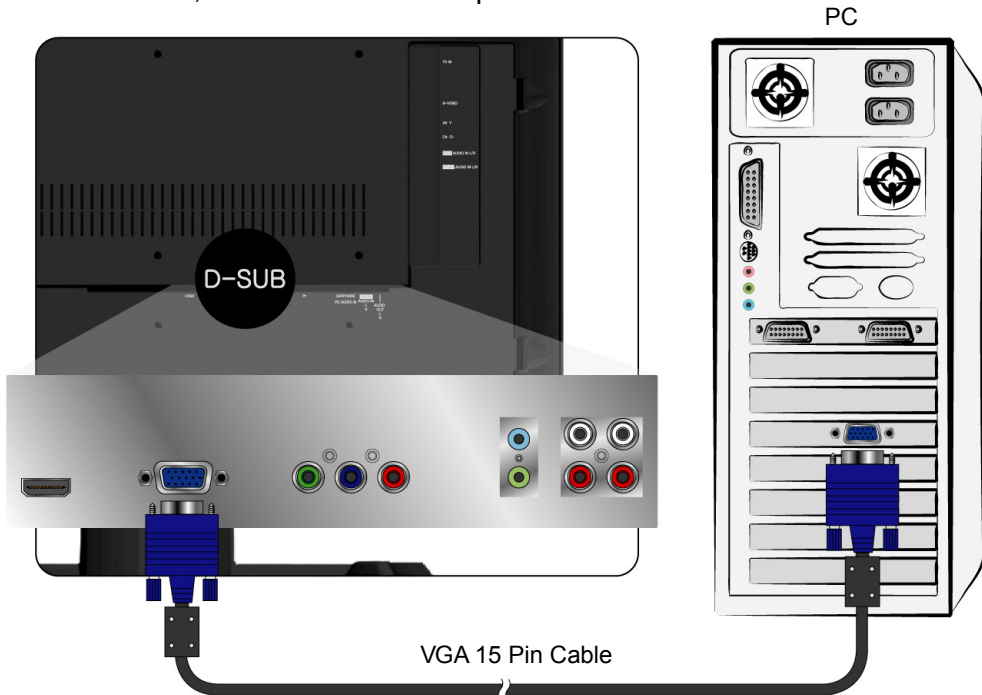

PC Audio in:

Connect the Audio In cable (green) from audio output of your PC to the audio input terminal (green) of N3250w.

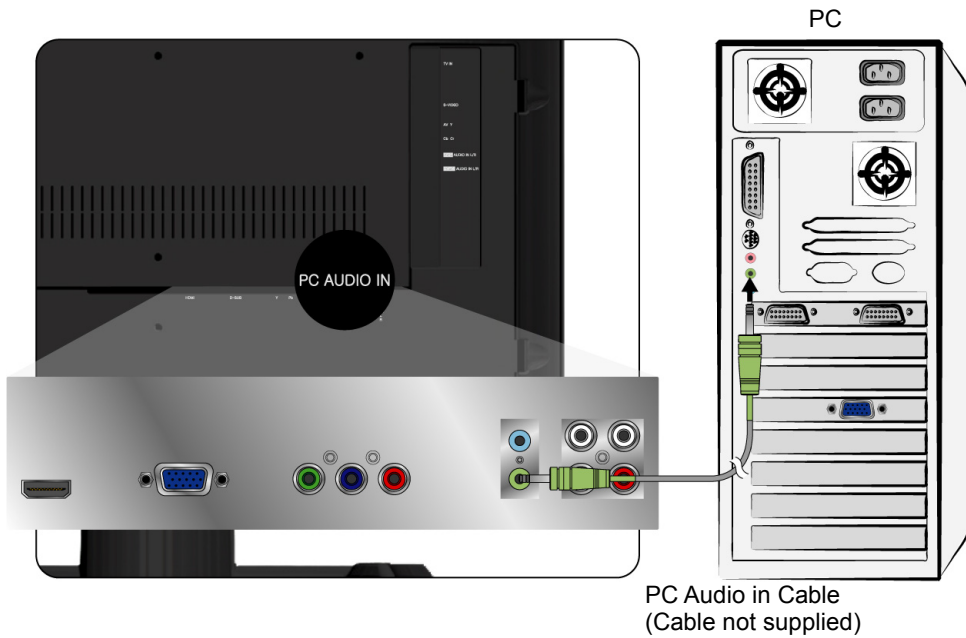

E
N
G
L
I
S
H

HDMI:

Connect the HDMI cable from HDMI output of PC to the DVI terminal input of N3250w.

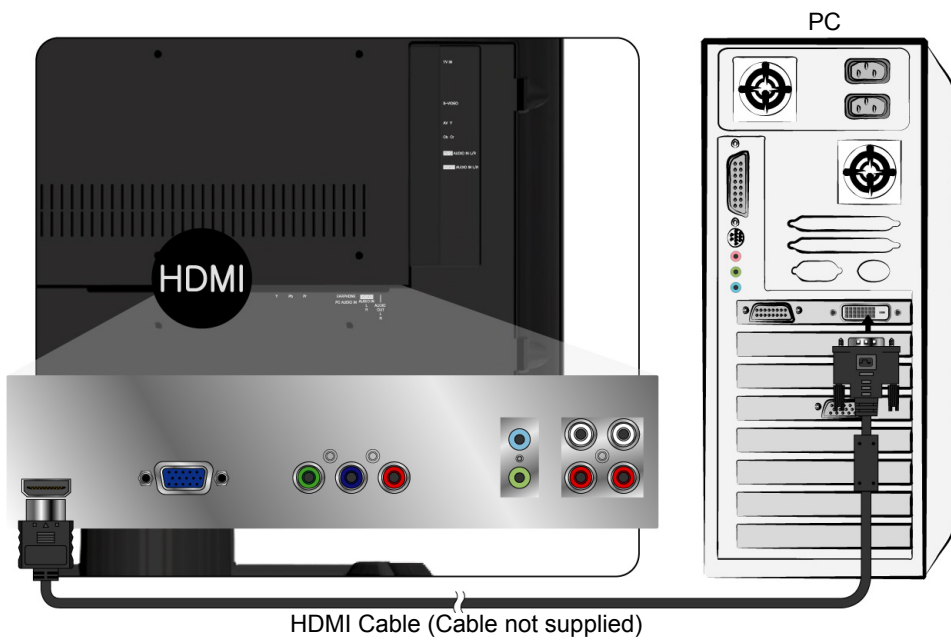

Earphone:

Connect Earphone from compatible devices into the back panel of N3250w.

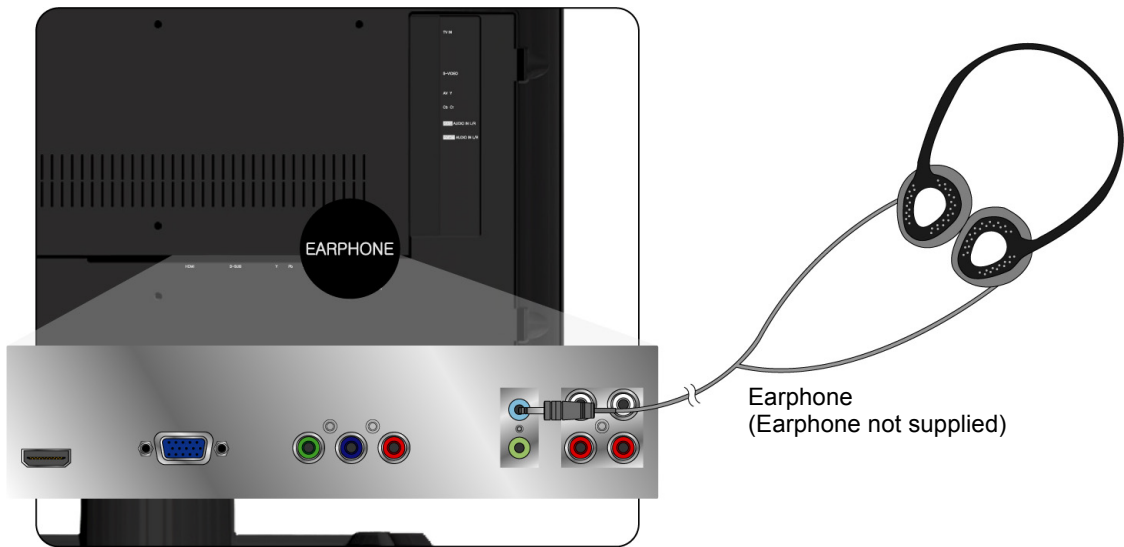

6. Connect power cable

Connect the power cord to the N3250w then to a properly grounded AC outlet. Turn on the AC Switch on the back of N3250w

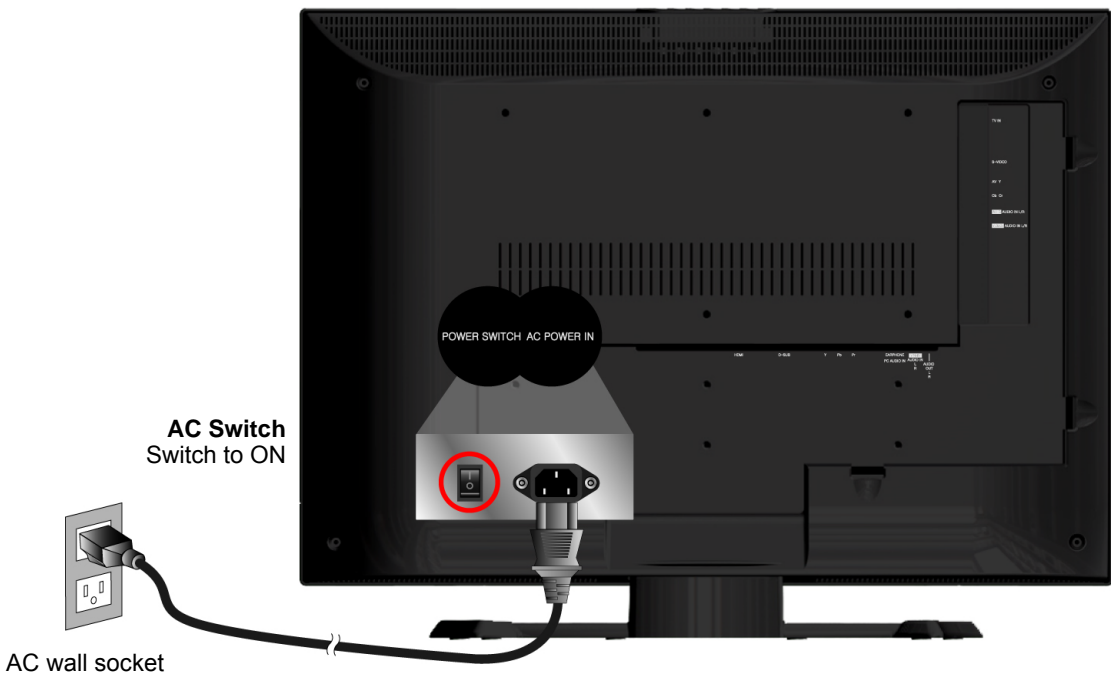

7. Turn Power ON

Press the Power button under the LCD TV, or press the Power On (red) button on the Remote Control. Turn Video source power ON.



8. Select input source for your LCDTV display, via either OSD menu or Remote control

The Source key of N3250w is the shortcut key for input selection.

- TV key of remote control is a shortcut for TV selection.

Basic Operation

To operate the function of your LCD TV, you can use your remote control or those buttons above your LCD TV to set input source, change channels, or adjust volume.

Turning on the LCD TV

Before using the LCD TV:

1. Insert the power plug.
2. Connect external equipment properly.
3. Turn on the Main AC Power Switch, located on the rear of the cabinet. (If the LCD TV will not be used for a long period of time, please turn it off)

Power On/Off

To turn the LCD TV on/off :

Press the POWER button under the LCD TV or press the Power button on your remote control to turn on/off the TV. The power LED indicator lights up when the LCD TV is on.

Select input source

To select the required input sources. Use ▼▲ to move the cursor bar, and select by pressing **Enter**.

VOLUME Adjusting

Press ◀▶ or **VOL-/+** to adjust the volume.

To silence the volume, press **MUTE**.

If you want to restore volume, press **MUTE** again, or press ◀▶ directly.

VOLUME



Channel Select

Press number key, **CH-/+** key or ▼▲ button to select your desired channel.

If your desired channel is below 100, directly press number key. If your desired channel is over 100, press **100** key first, and then press the other two number keys.

Ex: Your desired number is 8.

Press **0** ➡ press **8** or press **8** only.

Ex: Your desired number is 110.

Press **100** ➡ press **1** ➡ press **0**.

Retrn to last channel, press **RECALL**.

OSD Functions

- Press **MENU** to turn on OSD menu.
- To move the cursor bar, please use **CH** **▼▲** to select your desired item, and then press **ENTER**. In addition, you can adjust the volume by using **VOL** **”+”** or **“-”**.
- Press **◀▶** to adjust the condition.
- Press **MENU** again to get into next page of OSD menu.
Ex: When in page 1, press **MENU** for one time to get into page 2; two times to get into page 3.
- Press **MENU** for two or more seconds to turn off OSD menu

Source Input: TV

Page 1	PICTURE MENU
Page 2	INPUT SELECT
Page 3	PIP/POP MENU
Page 4	SETUP MENU
Page 5	TV MENU
Page 6	SOUND MENU
Page 7	PARENTAL CONTROL

Source Input: AV, S-Video, YCbCr

Page 1	PICTURE MENU
Page 2	INPUT SELECT
Page 3	PIP/POP MENU
Page 4	SETUP MENU
Page 5	SOUND MENU
Page 6	PARENTAL CONTROL

PICTURE MENU

BRIGHTNESS		50
CONTRAST		50
SHARPNESS		38
COLOR		50
TINT		50
FILM MODE	AUTO	
ASPECT RATIO	16:9	
3D COMB	ON	
NR FUNCTION	MEDIUM	
COLOR TEMPERATURE	MEDIUM	

▲▼ : SELECT ◀▶ : ADJUST MENU : NEXT PAGE

How to adjust the desired items:

Use **▼▲** to move cursor bar up and down ➡ Use **◀▶** to adjust or select the item ➡ press **ENTER** to confirm the selection.

BRIGHTNESS: To adjust the luminance of the image. (right: Max, left: low)

CONTRAST: To adjust the contrast ratio of the image. (right: high contrast, left: low contrast)

SHARPNESS: To adjust the sharpness of image. (right: sharpen, left: soften)

COLOR: To adjust color saturation. (right: brilliant color, left: pale color)

TINT: To adjust the video hue level. (right: more greenish tone, left: more reddish tone)

FILM MODE: To automatically convert the 24 film frame to the 60-field NTSC TV signal for viewing a motion picture on the TV.

ASPECT RATIO: To select the image size for 16:9 or 4:3 with ◀▶.

3D COMB: To provide high quality images with minimal dot crawl and cross color noise. (It is inactive when input source is S-video or YCbCr)

NR FUNCTION: To reduce the noise in picture.

COLOR TEMPERATURE: To select the color temperature between warm redder, medium neutral, or cool bluer.

Press **MENU** again to get into next Menu (INPUT SELECT).

Source Input: TV

Page 1	PICTURE MENU
Page 2	INPUT SELECT
Page 3	PIP/POP MENU
Page 4	SETUP MENU
Page 5	TV MENU
Page 6	SOUND MENU
Page 7	PARENTAL CONTROL

Source Input: AV, S-Video, YCbCr

Page 1	PICTURE MENU
Page 2	INPUT SELECT
Page 3	PIP/POP MENU
Page 4	SETUP MENU
Page 5	SOUND MENU
Page 6	PARENTAL CONTROL

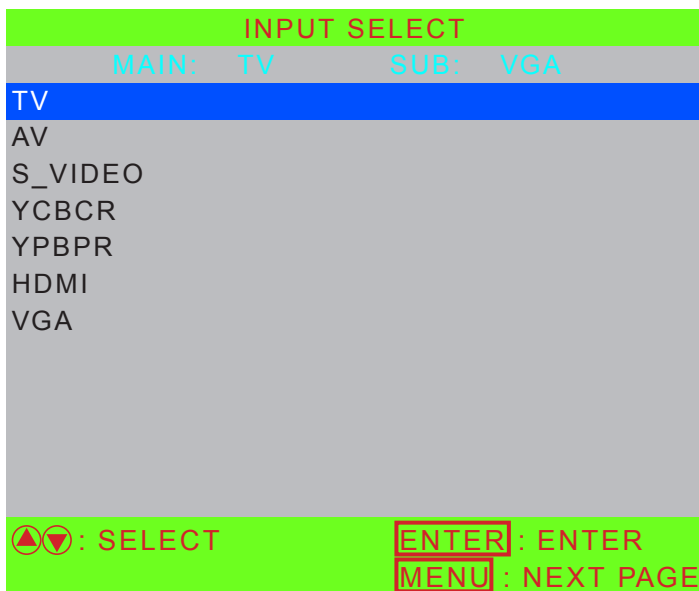

This page is to select your input sources, such as TV, AV, S-VIDEO, YCbCr, YPbPr, HDMI, and VGA.

How to select the input sources:

Use ▼▲ to move cursor bar up and down ➡ **ENTER** to input the desired item.
 Press **MENU** again to get into next Menu (PIP/POP MENU).

Source Input: TV

Page 1	PICTURE MENU
Page 2	INPUT SELECT
Page 3	PIP/POP MENU
Page 4	SETUP MENU
Page 5	TV MENU
Page 6	SOUND MENU
Page 7	PARENTAL CONTROL

Source Input: AV, S-Video, YCbCr

Page 1	PICTURE MENU
Page 2	INPUT SELECT
Page 3	PIP/POP MENU
Page 4	SETUP MENU
Page 5	SOUND MENU
Page 6	PARENTAL CONTROL

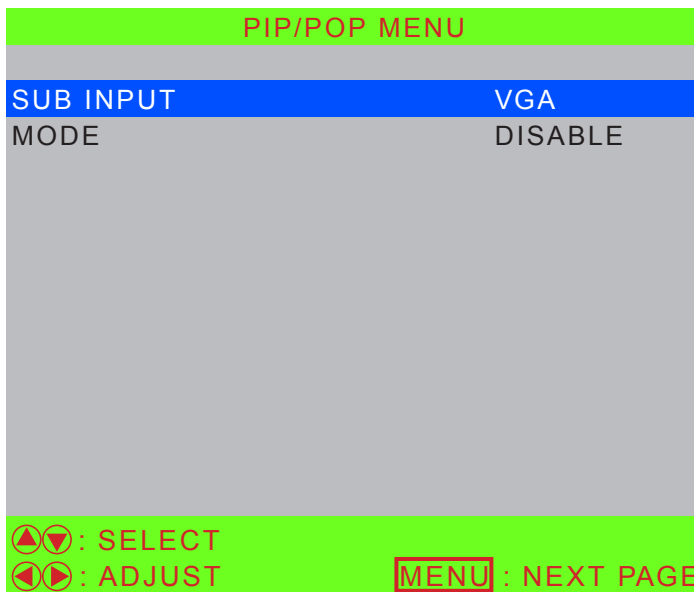

E
N
G
L
I
S
H

PIP/POP Menu allows you watch two screens from different sources at the same time. There are two kinds of screen for selection—PIP or POP screen.

How to select the desired items:

Use ▼▲ to move cursor bar up and down ➡ Use ◀▶ to select your desired item ➡ Press **ENTER** to input the instruction.

SUB INPUT: To select sub-screen input sources of PIP/POP. In PIP Menu, the input sources of sub-screen are specially designated as following,

The input sources in TV/ AV/ S-Video/ YCbCr mode are VGA YPbPr and HDMI.
MODE: To select PIP or POP screen with ◀▶. If you want to return to the full main screen, select “Disable.”

PIP Screen



POP Screen



When selecting PIP, it will show the other items to offer the adjusting function—SUB INPUT, MODE, AUDIO, SWAP, PIP SIZE, and PIP POSITION as following:

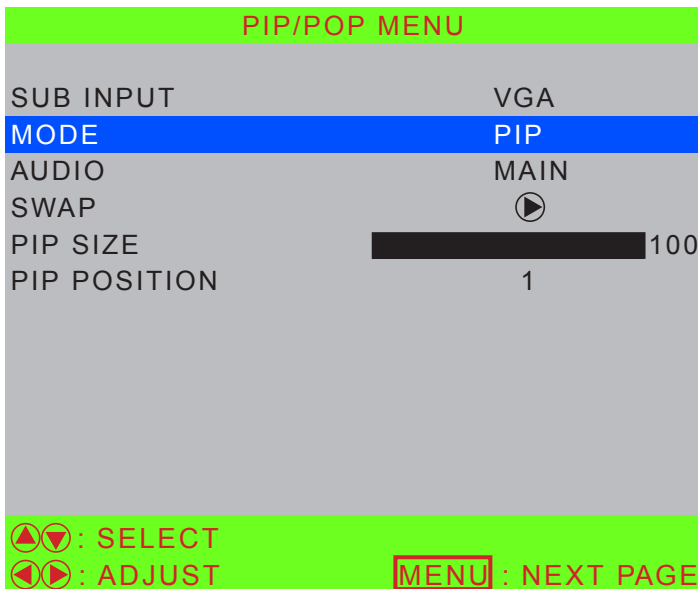

AUDIO: To select the source of sound: from main screen or sub-screen.

SWAP: To exchange main screen to sub-screen, including video and sound. Press ▶ to swap them.

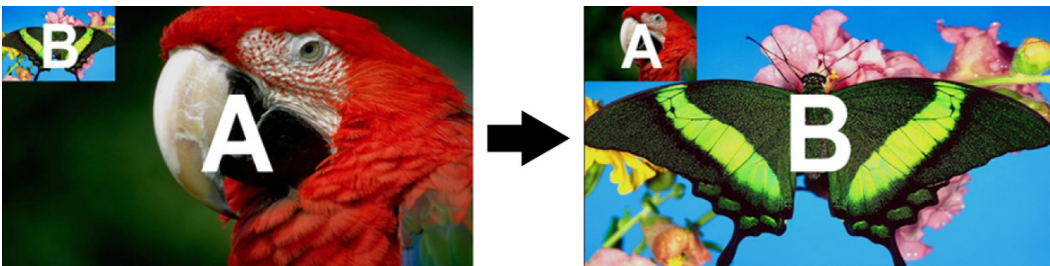

PIP SIZE: To adjust the size of sub-screen. The function only acts on PIP.

PIP POSITION: To set the position of sub-screen. This function only acts on PIP.



PIP/POP MENU

SUB INPUT	VGA
MODE	POP
AUDIO	MAIN
SWAP	▶

▲▼ : SELECT
 ◀▶ : ADJUST **MENU** : NEXT PAGE

When selecting POP, it will show the other items to offer the adjusting function—SUB INPUT, MODE, AUDIO, and SWAP.

Press **MENU** again to get into next Menu (SETUP MENU).

Source Input: TV

Page 1	PICTURE MENU
Page 2	INPUT SELECT
Page 3	PIP/POP MENU
Page 4	SETUP MENU
Page 5	TV MENU
Page 6	SOUND MENU
Page 7	PARENTAL CONTROL

Source Input: AV, S-Video, YCbCr

Page 1	PICTURE MENU
Page 2	INPUT SELECT
Page 3	PIP/POP MENU
Page 4	SETUP MENU
Page 5	SOUND MENU
Page 6	PARENTAL CONTROL

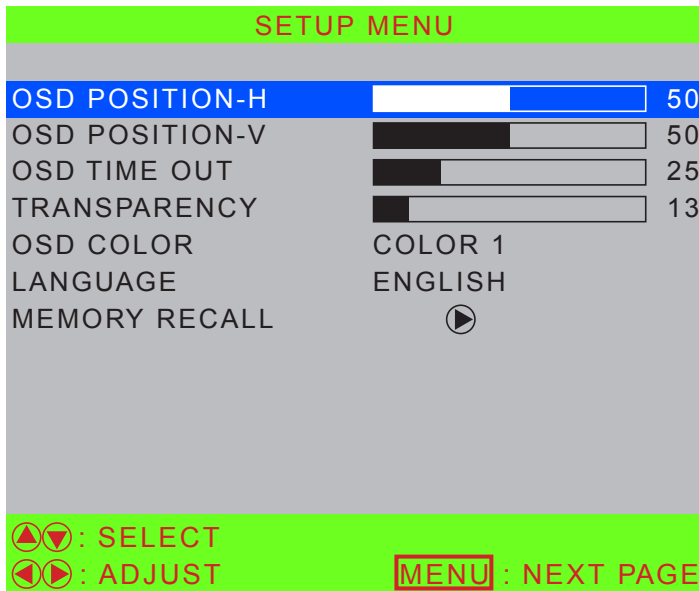

OSD POSITION-H: To adjust the horizontal position of OSD.

OSD POSITION-V: To adjust the vertical position of OSD.

OSD TIME OUT: To setup the displaying time of OSD.

TRANSPARENCY: To adjust the transparency of OSD.

OSD COLOR: To select your favorite OSD color.

LANGUAGE: To select OSD Language.

MEMORY RECALL: Recall factory pre-sets.

Press **MENU** again to get into next Menu (TV MENU in TV Mode, SOUND MENU in AV, S-Video, YCbCr Mode).

(It does not function in any other mode except in TV mode)

Source Input: TV

Page 1	PICTURE MENU
Page 2	INPUT SELECT
Page 3	PIP/POP MENU
Page 4	SETUP MENU
Page 5	TV MENU
Page 6	SOUND MENU
Page 7	PARENTAL CONTROL

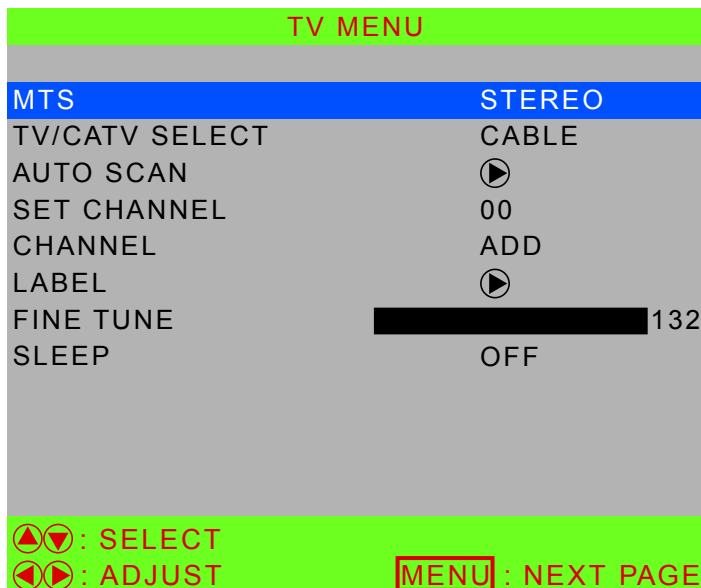

MTS: The function is to provide the multi-channel TV sound. The system with MTS can receive Dual, Stereo, SAP(Secondary Audio Program), or Mono sound. Both Stereo and Mono sound receive from TV broadcasts in main sound. However, the SAP feature permits the TV station to broadcast other information, so that it can be audio in another language. With Dual sound, you can enjoy the main sound (normal program soundtrack) and the second language at the same time.

TV/CATV SELECT: To select TV signal input from Cable or Air.

AUTO SCAN: To auto scan the TV channels (TV or CATV).

1. Function: To automatically preset the channels into TV. Kindly suggest you auto scan all the channels before watching your TV for the first time.
2. After auto scan all the channels, you need not to do it again when turning on your TV next time.

SET CHANNEL: To select your desired channels by ◀▶.

CHANNEL: To add or delete the appointed TV channel.

How to do?

1. Use the function “SET CHANNEL” to select the desired channel.
2. Move your cursor bar to CHENNEL by using ▼▲.
3. Press ◀ or ▶ one time to add or delete the appointed channel.
4. Press **ENTER** to confirm the selection.

Ps. After input the instruction of Add/Del Channel, as running the channels by using ▼▲ with your remote control, the channel you deleted will be passed over, and the channel you added will be shown up.

To restore the deleted channels, you may add the channels by Add function, or by Auto Scan to preset them.

LABEL: To set a name for the channel with 0~9 and A~Z.

How to set a name for the channel?

1. Move your cursor bar to LABEL by using ▼▲.
2. Press ► to get into the CHANNEL LABEL page.
3. Use ◀▶ or ▼▲ to pick up the numbers or letters, and then press **ENTER** to input the words.
4. After setting a name, move your cursor to SAVE then press **ENTER** for saving the input.

How do I cancel the name?

1. Get into the CHANNEL LABEL page (see above instruction).
2. Move your cursor by using ◀▶ to select the “blank,” which is the last in the line of numbers, exactly beside “--.”
3. Press **ENTER** several times to delete the name.



FINE TUNE: To improve TV channel reception when needed. Use ▼▲ to move your cursor to Fine Tune, then press ◀▶ to adjust it.

SLEEP TIME: To set up the off timer. There are several kinds of timing to choose: 10 min, 20 min, 30min, 40 min, 50 min, and 60min. To turn off sleep time function, choose Off.

Press **MENU** again to get into next Menu (SOUND MENU).

Source Input: TV

Page 1	PICTURE MENU
Page 2	INPUT SELECT
Page 3	PIP/POP MENU
Page 4	SETUP MENU
Page 5	TV MENU
Page 6	SOUND MENU
Page 7	PARENTAL CONTROL

Source Input: AV, S-Video, YCbCr

Page 1	PICTURE MENU
Page 2	INPUT SELECT
Page 3	PIP/POP MENU
Page 4	SETUP MENU
Page 5	SOUND MENU
Page 6	PARENTAL CONTROL

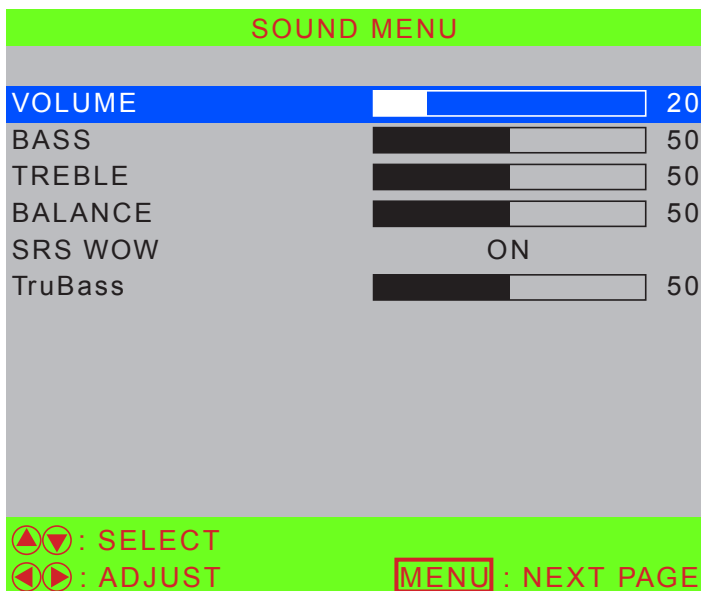

VOLUME: To adjust the volume.

BASS: To adjust the bass.

TREBLE: To adjust the treble.

BALANCE: To adjust the left and right audio balance.

SRS WOW: To turn SRS(WOW) on/off.

Tru Bass: To adjust the tru bass.

Press **MENU** again to get into next Menu (PARENTAL CONTROL).

Source Input: TV

Page 1	PICTURE MENU
Page 2	INPUT SELECT
Page 3	PIP/POP MENU
Page 4	SETUP MENU
Page 5	TV MENU
Page 6	SOUND MENU
Page 7	PARENTAL CONTROL

Source Input: AV, S-Video, YCbCr

Page 1	PICTURE MENU
Page 2	INPUT SELECT
Page 3	PIP/POP MENU
Page 4	SETUP MENU
Page 5	SOUND MENU
Page 6	PARENTAL CONTROL

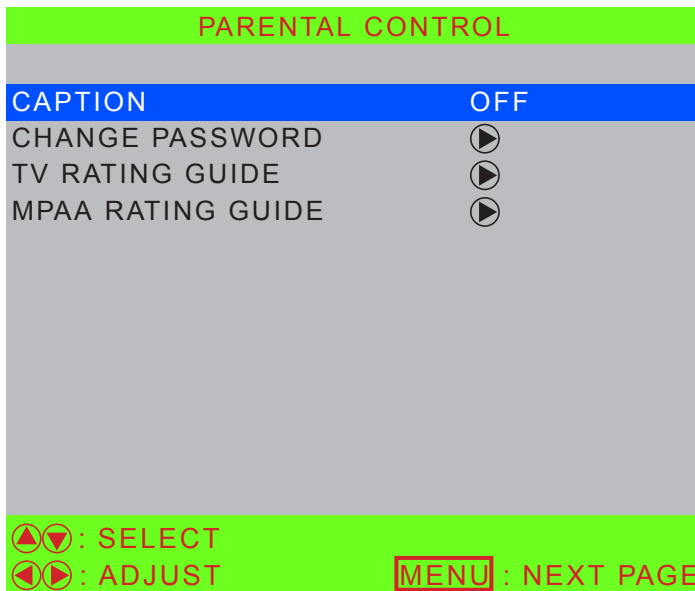

Parental control is to set up V-Chip condition and password. V-Chip is transmitted from TV station to help parents monitor what their children watch. According to the pre-set of factory, viewers can see all of the channels. However, setting V-Chip can block the appointed channels. The parental control lists settings for two types of guidelines—Television Rating Guide and Movie Rating Guide.

CAPTION: To set up close caption mode. (CC1~CC4, TX1~TX4)

CHANGE PASSWORD: To re-set your password.

How to do?

1. Move the cursor to the item of CHANGE PASSWORD.
2. Press ►.
3. There will appear captions “ENTER PASSWORD.”

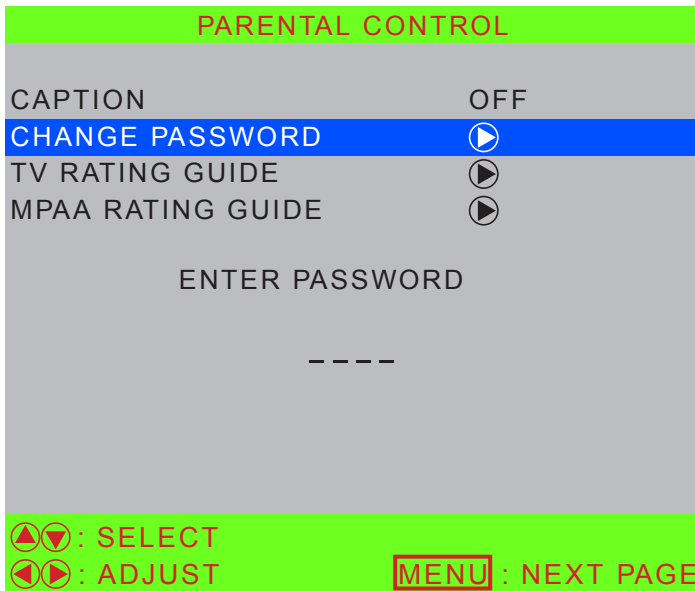

4. Enter 0000 if you have not assigned the special password.

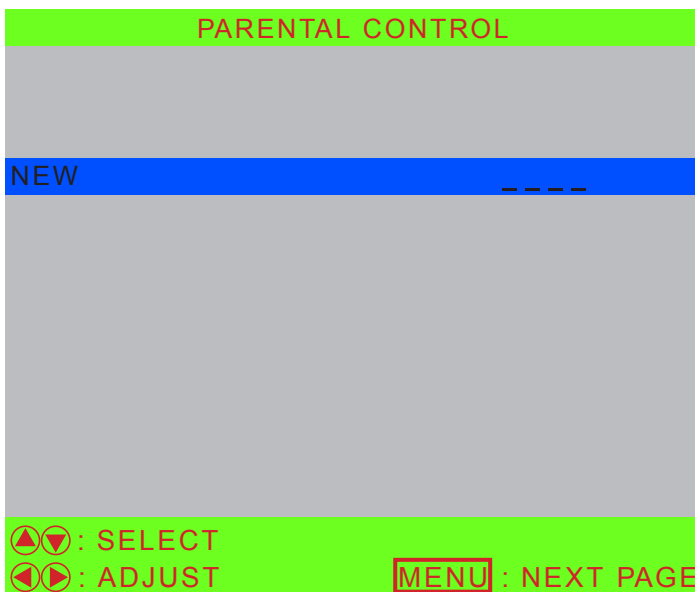

5. Use remote control to enter four digit numbers to set the new password.

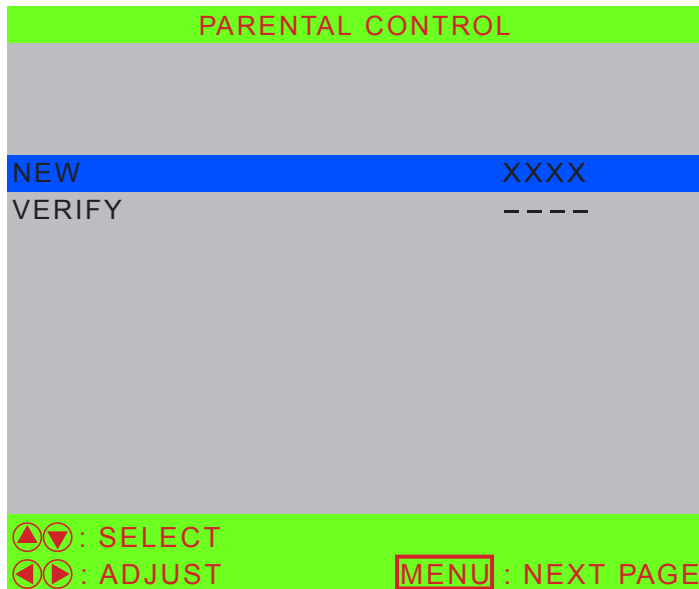

6. Enter the 4 digit numbers again to verify your new password, and then it will show OK on the screen, and then turn back to the Parental Control page.

TV RATING GUIDE: To setup TV Rating.

How to set up TV Rating?

1. Move the cursor to the item of TV RATING GUIDE.
2. Press ►.
3. There will appear captions “ENTER PASSWORD.” Input your password with your remote control.

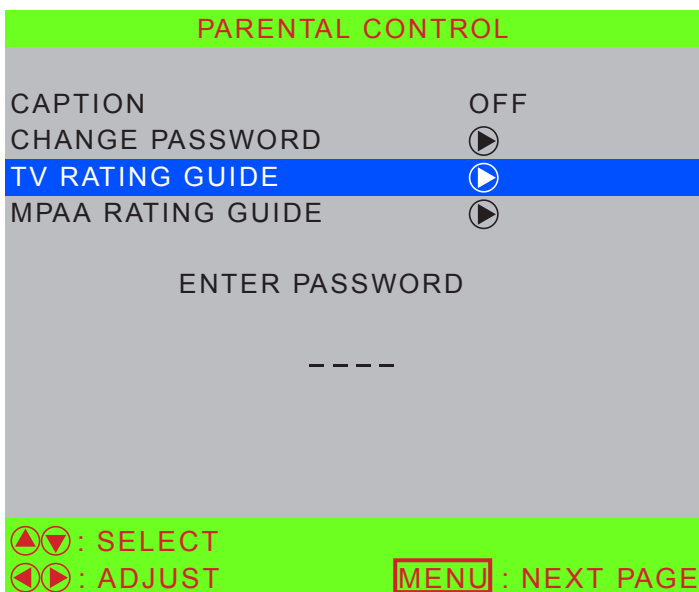

4. Select your TV Rating.

PARENTAL CONTROL

TV RATING
 TV Y: U
 TV Y7: U FVU
 TV G: U
 TV PG: U DU LU SU VU
 TV 14: U DU LU SU VU
 TV MA: U LU SU VU

▲▼ : SELECT ENTER : ENTER
◀▶ : ADJUST MENU : NEXT PAGE

5. Move the cursor by using ▼▲ to select the rating grade you expect to block.
6. Press **ENTER** to set block or unblock condition. ("B" means block; "U" means unblock.)

The TV Ratings are defined as following

TV-Y	All children	TV-PG	Parental guidance suggested
TV-Y7	Directed to older children: this program is designed for children age 7 and above	TV-14	Parents strongly cautioned: this program contains some material that is unsuitable for children under 14 years of age
TV-G	General audience	TV-MA	Mature audience only

MPAA RATING GUIDE: To setup the movie ratings.

Enter your password with your remote control.

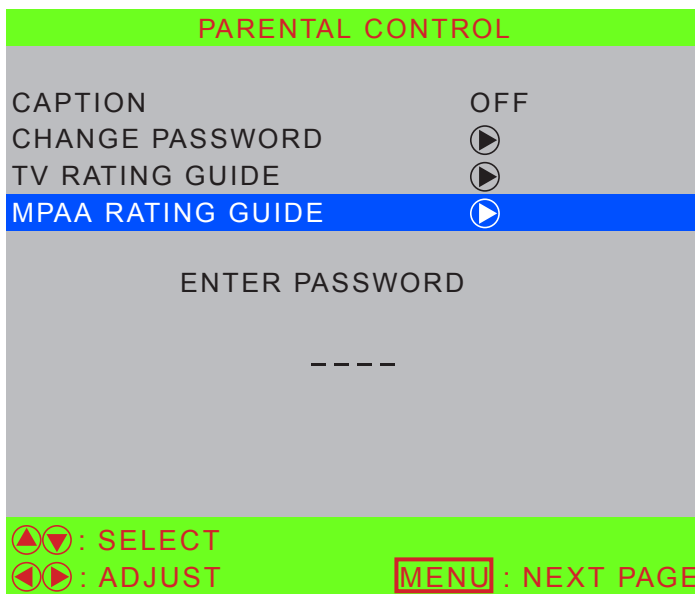

You can reference the operating steps of TV RATING GUIDE, for they are the same way as MPAA RATING GUIDE.

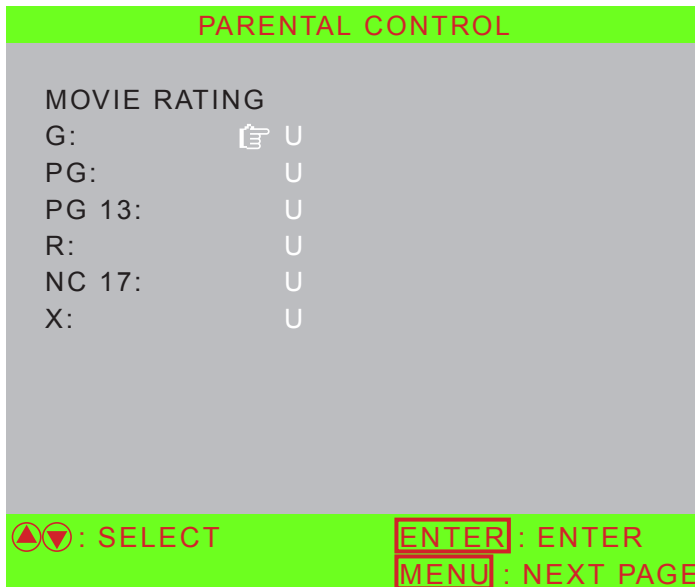

The Movie Ratings are defined as following

G	General audience	R	Restricted
PG	Parental guidance suggested	NC-17	No one 17 and under limited
PG-13	Parents strongly cautioned.	X	Adult audience only

Source Input: VGA, HDMI, YPbPr

The menus in VGA, HDMI, and YPbPr mode are as following:

In VGA Mode:

Page 1	PICTURE MENU
Page 2	INPUT SELECT
Page 3	PIP/POP MENU
Page 4	SETUP MENU
Page 5	SOUND MENU

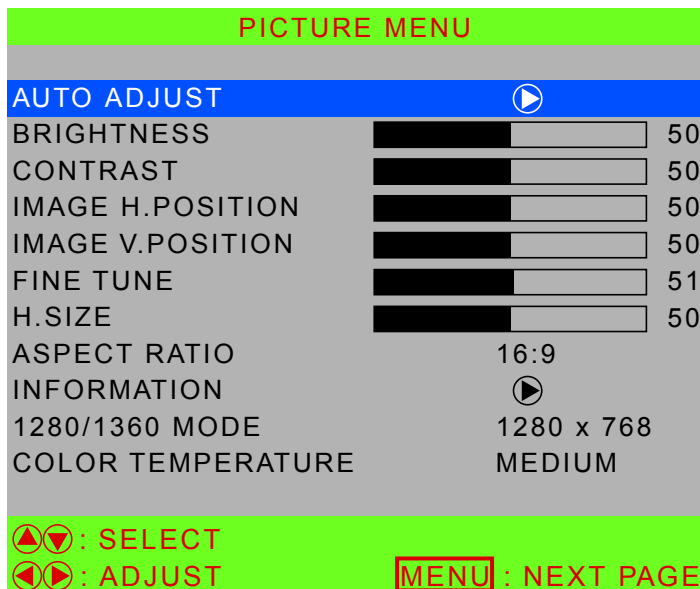

How to adjust the desired items:

Use ▼▲ to move cursor bar up and down ➡ Use ◀▶ to adjust the item.

AUTO ADJUST: Auto adjust picture's Horizontal position, Vertical position, Fine Tune and H.Size. Press ▶ to start the function.

BRIGHTNESS: To adjust the luminance of the image. (right: Max, left: low)

CONTRAST: To adjust the contrast ratio of the image. (right: high contrast, left: low contrast)

IMAGE H.POSITION: To adjust the horizontal position of the video with ◀▶.

IMAGE V.POSITION: To adjust the vertical position of the video with ◀▶ (When aspect ratio is 4:3, it is inactive).

FINE TUNE: To adjust the delay time of data and clock with ◀▶ .

H.SIZE: To adjust the horizontal pixel clock of the video.

ASPECT RATIO: To select the image size for 16:9 or 4:3 with ◀▶.

INFORMATION: To show displaying mode condition. Press ▶ to show the current resolution.

1280/1360 MODE: To help TV's resolution match with computer's resolution for the sake of better picture. Select the resolution between 1280 x 768 and 1360 x 768. If the computer's resolution is not 1280 x 768 or 1360 x 768, the function is inactive.

COLOR TEMPERATURE: To select the color temperature between warm redder, medium neutral and cool bluer.

Press **MENU** again to get into next Menu (INPUT SELECT).

In HDMI Mode:

Page 1	PICTURE MENU
Page 2	INPUT SELECT
Page 3	PIP/POP MENU
Page 4	SETUP MENU
Page 5	SOUND MENU

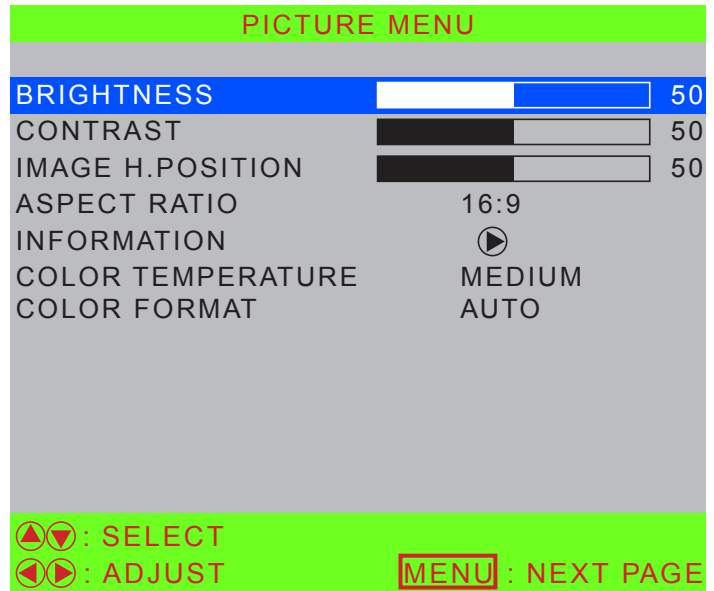

How to adjust the desired items:

Use ▼▲ to move cursor bar up and down ➡ Use ◀▶ to adjust the item.

BRIGHTNESS: To adjust the luminance of the image. (right: Max, left: low)

CONTRAST: To adjust the contrast ratio of the image. (right: high contrast, left: low contrast)

IMAGE H.POSITION: To adjust the horizontal position of the video with ◀▶. (It is inactive in PIP/ POP condition)

ASPECT RATIO: To select the image size for 16:9 or 4:3 with ◀▶. (It is inactive in PIP/ POP condition)

INFORMATION: To show displaying mode condition. Press ▶ to show the current resolution.

COLOR TEMPERATURE: To select the color temperature between warm redder, medium neutral and cool bluer.

COLOR FORMAT: To manually select the proper HDMI color format between RGB and YUV, or select Auto to detect the format automatically.

Note: When manually selecting improper color format (RGB or YUV), the picture's color will be abnormal, Try to select the other one.

Press **MENU** again to get into next Menu (INPUT SELECT).

In YPbPr Mode:

Page 1	PICTURE MENU
Page 2	INPUT SELECT
Page 3	PIP/POP MENU
Page 4	SETUP MENU
Page 5	SOUND MENU

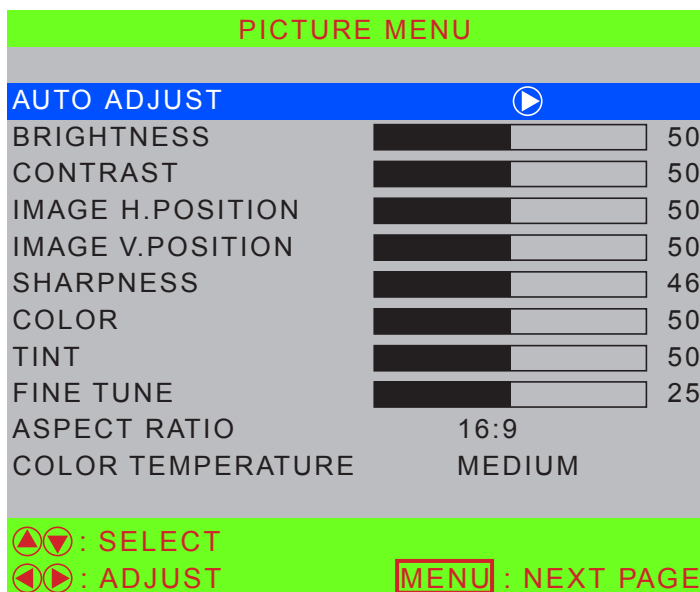

How to adjust the desired items:

Use ▼▲ to move cursor bar up and down ➡ Use ◀▶ to adjust the item.

AUTO ADJUST: Auto adjust picture's Horizontal position, Vertical position, Fine Tune and H.Size. Press ▶ to start the function.

BRIGHTNESS: To adjust the luminance of the image. (right: Max, left: low)

CONTRAST: To adjust the contrast ratio of the image. (right: high contrast, left: low contrast)

IMAGE H.POSITION: To adjust the horizontal position of the video with ◀▶. (It is inactive in PIP/ POP condition)

IMAGE V.POSITION: To adjust the vertical position of the video with ◀▶. (It is inactive in PIP/ POP condition)

SHARPNESS: To adjust the sharpness of image. (right: sharpen, left: soften)

COLOR: To adjust color saturation. (right: brilliant color, left: pale color)

TINT: To adjust the video hue level. (right: more greenish tone, left: more reddish tone)

FINE TUNE: To adjust the delay time of data and clock with ◀▶.

ASPECT RATIO: To select the image size for 16:9, 4:3 with ◀▶. (It is inactive in PIP/ POP condition)

COLOR TEMPERATURE: To select the color temperature between warm redder, medium neutral and cool bluer.

Press **MENU** again to get into next Menu (INPUT SELECT).

Source Input: VGA, HDMI, YPbPr

Page 1	PICTURE MENU
Page 2	INPUT SELECT
Page 3	PIP/POP MENU
Page 4	SETUP MENU
Page 5	SOUND MENU

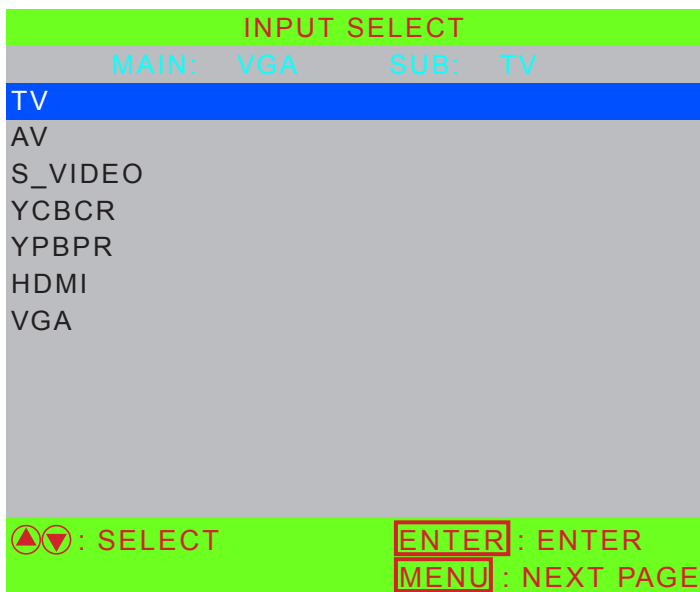

This page is to select your input sources, such as TV, AV, S-VIDEO, YCbCr, YPbPr, HDMI, and VGA.

How to select the input sources:

Use ▼▲ to move cursor bar up and down ➡ **ENTER** to input the desired item.

Press **MENU** again to get into next Menu (PIP/POP MENU).

Source Input: VGA, HDMI, YPbPr

Page 1	PICTURE MENU
Page 2	INPUT SELECT
Page 3	PIP/POP MENU
Page 4	SETUP MENU
Page 5	SOUND MENU

The functions of PIP/ POP Menu in VGA, HDMI, and YPbPr are the same as they are in TV, AV, S-Video, and YCbCr.

Note: The available sub-screen input sources in VGA, HDMI, and YPbPr mode are TV, AV, S-Video, and YCbCr.

About the operation, please refer to page 30~32.

Press **MENU** again to get into next Menu (SETUP MENU).

Source Input: VGA, HDMI, YPbPr

Page 1	PICTURE MENU
Page 2	INPUT SELECT
Page 3	PIP/POP MENU
Page 4	SETUP MENU
Page 5	SOUND MENU

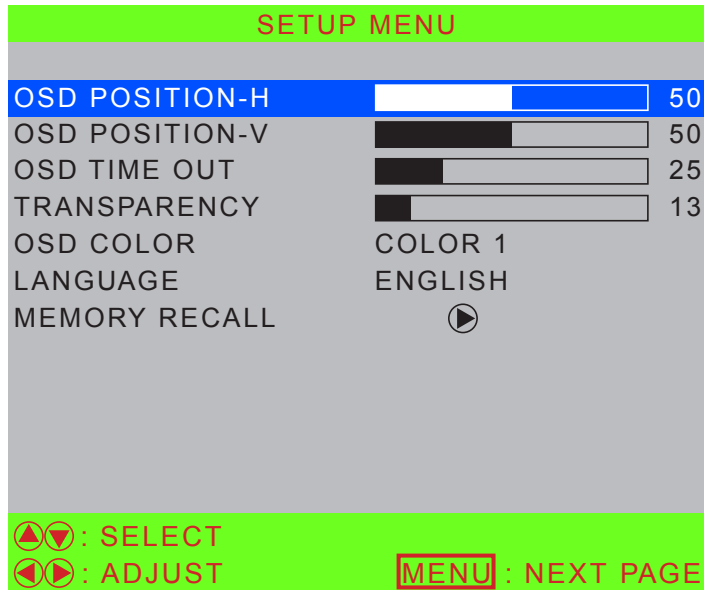

OSD POSITION-H: To adjust the horizontal position of OSD.

OSD POSITION-V: To adjust the vertical position of OSD.

OSD TIME OUT: To setup the displaying time of OSD.

TRANSPARENCY: To adjust the transparency of OSD.

OSD COLOR: To select your favorite OSD color.

LANGUAGE: To select OSD Language.

MEMORY RECALL: Recall factory pre-sets.

Press **MENU** again to get into next Menu (SOUND MENU).

Source Input: VGA, HDMI, YPbPr

Page 1	PICTURE MENU
Page 2	INPUT SELECT
Page 3	PIP/POP MENU
Page 4	SETUP MENU
Page 5	SOUND MENU

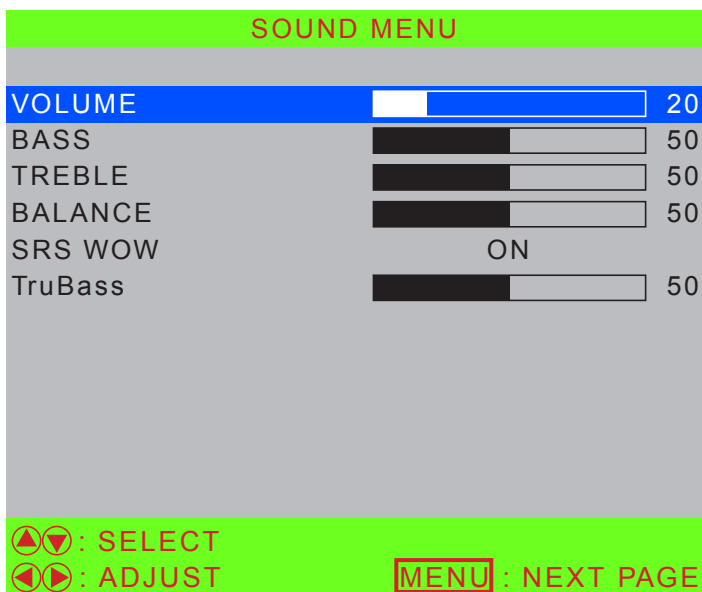

VOLUME: To adjust the volume.

BASS: To adjust the bass.

TREBLE: To adjust the treble.

BALANCE: To adjust the left and right audio balance.

SRS WOW: To turn SRS(WOW) on/off.

Tru Bass: To adjust the tru bass.

HDMI AUDIO (Override): To select HDMI audio from HDMI, VGA, YPbPr, or YCbCr (It is only active in HDMI mode).

Other Information

Specifications

LCD	Type	31.5" view able 0.57075(H) x 0.57075(V) mm pixel pitch
	Color Filter	RGB vertical stripe
	Glass surface	Anti-Glare
Input signal	RGB	RGB analog (0.7/1.0 Vp-p, 75 ohms) Separate Sync, f _h :30-80 kHz, f _v :50-75 Hz
	RF	TV system Antenna/NTSC
	Video	1 compsite RCA, 1 S-Video, 1 YCbCr component, 1YPbPr component, 1 HDMI
	Audio	1 mini-stereo, 3 pair of RCA (L/R) stereo
Compatibility	PC	Up to 1360 x 768 Non-interlaced
Resolution	Recommended and supported	1360 x 768 @ 60 Hz
		1280 x 1024 @ 60 Hz
		1024 x 768 @ 60, 75 Hz
		800 x 600 @ 60, 75 Hz
		640 x 480 @ 60, 75 Hz
Speaker Output		10W x 2
Audio Output		1 pair of RCA (L/R) stereo jack
Power	Voltage	100-240 VAC, 50/60 Hz (auto switch)
Display area	Full Scan	697.65 mm (H) x 392.26 mm (V) 27.5" (H) x 15.4" (V)
Operating conditions	Temperature	32° F to + 104° F (0° C to + 40° C)
	Humidity	10% to 65% (no condensation)
	Altitude	To 10,000 feet (3,000m)
Storage conditions	Temperature	-4° F to + 140° F (-20° C to + 60° C)
	Humidity	10% to 90% (no condensation)
	Altitude	To 40,000 feet (12,000m)
Dimensions	Physical	808 mm (W) x 623 mm (H) x 243 mm (D) 31.8" (W) x 24.5" (H) x 9.6" (D)
Weight	Net	19.8 kg (43.6 lb)
Regulations		UL, FCC-B (Doc-B)
Power saving modes	On	<200W (green LED)
	Active Off	<5W (red LED)

Preset Timing Mode (pre-adjusted to GTF 1360 x 768 @ 60 Hz)

Warning: Do not set the graphics card in your computer to exceed these refresh rates; doing so may result in permanent damage to the LCD display.

Note: Product Specification are subject to change without notice.

Troubleshooting

No power

- Make sure power button (and rear power switch) is ON.
- Make sure A/C power cord is securely connected to the LCD TV.
- Plug another electrical device (like a radio) into the power outlet to verify that the outlet is supplying proper voltage.

Power is ON but no screen image

- Make sure the video cable supplied with the LCD TV is tightly secured to the video output port on the back of the Video source. If the other end of the video cable was not attached permanently to the LCD TV, tightly secure it to the LCD TV.
- Adjust brightness and contrast.
- Check Source settings.
- Make sure the signal source is compative with the LCD TV.

Wrong or abnormal colors

- If any colors (red, green, or blue) are missing, check the video cable to make sure it is securely connected. Loose or broken pins in the cable connector could cause an improper connection.
- Connect the LCD display to another Video source.

Control buttons do not work

- Press only one button at a time.

Snow appears on screen

- Check your antenna connection.
- Check TV/CATV selection.

No Sound

- Check your audio connection in accordance with Video source.
- Press Mute again, so that Mute disappears from the screen.
- Check you NICAM settings.
- Press the Volume + key on your remote controller.

Remote control doesn't work

- Make sure batteries been inserted correctly.
- Batteries could be weak, replace batteries.

NO picture in PC mode

- Set PC to "1024 x 768" or "1360 x 768" @ 60 Hz signal timing.

Customer Support

For technical support or product service, see the table below or contact your reseller.

NOTE: You will need the product serial number.

Contry/ Region	Web site	T = Telephone F = FAX	Email
United States	viewsonic.com/support	T: (800) 688-6688 F: (909) 468-1202	service.us@ viewsonic.com
Canada	viewsonic.com/support	T: (800) 688-6688 F: (909) 468-1202	service.ca@ viewsonic.com

Limited Warranty

VIEWSONIC LCD DISPLAY

What the warranty covers:

ViewSonic® warrants its products to be free from defects in material and workmanship during the warranty period. If a product proves to be defective in material or workmanship during the warranty period, **ViewSonic** will, at its sole option, repair or replace the product with a like product. Replacement product or parts may include remanufactured or refurbished parts or components.

How long the warranty is effective:

ViewSonic N3250w is warranted for one (1) year for all parts including the light source and one (1) year for all labor from the date of the first consumer purchase.

Who the warranty protects:

This warranty is valid only for the first consumer purchaser.

What the warranty does not cover:

1. Any product on which the serial number has been defaced, modified or removed.
2. Damage, deterioration or malfunction resulting from:
 - a. Accident, misuse, neglect, fire, water, lightning, or other acts of nature, unauthorized product modification, or failure to follow instructions supplied with the product.
 - b. Repair or attempted repair by anyone not authorized by **ViewSonic**.
 - c. Any damage of the product due to shipment.
 - d. Removal or installation of the product.
 - e. Causes external to the product, such as electrical power fluctuations or failure.
 - f. Use of supplies or parts not meeting **ViewSonic**'s specifications.
 - g. Normal wear and tear.
 - h. Any other cause which does not relate to a product defect.
3. Removal, installation, and set-up service charges.

How to get service:

1. For information about receiving service under warranty, contact **ViewSonic Customer Support**. You will need to provide your product's serial number.
2. To obtain service under warranty, you will be required to provide (a) the original dated sales slip, (b) your name, (c) your address, (d) a description of the problem, and (e) the serial number of the product.
3. Take or ship the product freight prepaid in the original container to an authorized **ViewSonic** service center or **ViewSonic**.
4. For additional information or the name of the nearest **ViewSonic** service center, contact **ViewSonic**.

Limitation of implied warranties:

THERE ARE NO WARRANTIES, EXPRESS OR IMPLIED, WHICH EXTEND BEYOND THE DESCRIPTION CONTAINED HEREIN INCLUDING THE IMPLIED WARRANTY OF MERCHANTABILITY AND FITNESS FOR A PARTICULAR PURPOSE.

Exclusion of damages:

VIEWSONIC'S LIABILITY IS LIMITED TO THE COST OF REPAIR OR REPLACEMENT OF THE PRODUCT. VIEWSONIC SHALL NOT BE LIABLE FOR:

1. DAMAGE TO OTHER PROPERTY CAUSED BY ANY DEFECTS IN THE PRODUCT, DAMAGES BASED UPON INCONVENIENCE, LOSS OF USE OF THE PRODUCT, LOSS OF TIME, LOSS OF PROFITS, LOSS OF BUSINESS OPPORTUNITY, LOSS OF GOODWILL, INTERFERENCE WITH BUSINESS RELATIONSHIPS, OR OTHER COMMERCIAL LOSS, EVEN IF ADVISED OF THE POSSIBILITY OF SUCH DAMAGES.
2. ANY OTHER DAMAGES, WHETHER INCIDENTAL, CONSEQUENTIAL OR OTHERWISE.
3. ANY CLAIM AGAINST THE CUSTOMER BY ANY OTHER PARTY.

Effect of state law:

This warranty gives you specific legal rights, and you may also have other rights which vary from state to state. Some states do not allow limitations on implied warranties and/or do not allow the exclusion of incidental or consequential damages, so the above limitations and exclusions may not apply to you.

Sales outside the U.S.A. and Canada:

For warranty information and service on ViewSonic products sold outside of the U.S.A. and Canada, contact ViewSonic or your local ViewSonic dealer.

ViewSonic LCD Warranty (V3.0)

Release Date: 0 1- 29- 2002

Appendix

Safety Guidelines

Warning: This device must be operated with the original power supply, part number: 12VDC LSE9901B1250, 12VDC UP06031120.

CAUTION: The socket-outlet should be installed near the equipment and should be easily accessible.

CAUTION: Use a power cable that is properly grounded. Always use the appropriate AC cord that is certified for the individual country. Some examples are listed below:

- | | |
|-----------------|--|
| USA.....UL | Switzerland SEV |
| Canada.....CSA | Britain BASE/BS |
| Germany.....VDE | Japan Electric Appliance Control Act |

IMPORTANT NOTICE CONCERNING POWER CORD SELECTION

The power cord set for this unit has been enclosed and has been selected according to the country of destination and must be used to prevent electric shock. Use the following guidelines if it is necessary to replace the original cord set, or if the cord set is not enclosed.

The female receptacle of the cord set must meet IEC-60320 requirements and may look like (Figure A1 below):

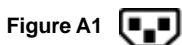

For the United States and Canada

In the United States and Canada the male plug is a NEMA5-15 style (Figure A2), UL Listed, and CSA Labeled. For units which are mounted on a desk or table, type SVT or SJT cord sets may be used. For units which sit on the floor, only SJT type cord sets may be used. The cord set must be selected according to the current rating for your unit. Please consult the table below for the selection criteria for power cords used in the United States and Canada.

Cord Type	Size of Conductors in Cord	Maximum Current Rating of Unit
SJT	18 AWG 16 AWG 14 AWG	10 Amps 12 Amps 12 Amps
SVT	18 AWG 17 AWG	10 Amps 12 Amps

For European Countries

In Europe you must use a cord set which is appropriate for the receptacles in your country. The cord set is HAR-Certified, and a special mark that will appear on the outer sheath, or on the insulation of one of the inner conductors.

AC PLUG CORD PRECAUTIONS FOR THE UNITED KINGDOM

FOR YOUR SAFETY PLEASE READ THE FOLLOWING TEXT CAREFULLY.

IF THE FITTED MOULDED PLUG IS UNSUITABLE FOR THE SOCKET OUTLET THEN THE PLUG SHOULD BE CUT OFF AND DISPOSED OF SAFELY.

THERE IS A DANGER OF SEVERE ELECTRICAL SHOCK IF THE CUT OFF PLUG IS INSERTED INTO AN APPROPRIATE SOCKET.

If a new plug is to be fitted, please observe the wiring code as shown below.

If in any doubt, please consult a qualified electrician.

WARNING: THIS APPLIANCE MUST BE EARTHED.

IMPORTANT: The wires in this mains lead are coloured in accordance with the following code:

- Green-and-Yellow: Earth
- Blue: Neutral
- Brown: Live

If the coloured wires of the mains lead of this appliance do not correspond with the coloured markings identifying the terminals in your plug, proceed as follows:

The wire which is coloured GREEN-AND-YELLOW must be connected to the terminal in the plug which is marked by the letter E or by the Earth symbol or coloured GREEN or GREEN-AND-YELLOW.

The wire which is coloured BLUE must be connected to the terminal in the plug which is marked with the letter N or coloured BLACK. The wire which is coloured BROWN must be connected to the terminal in the plug which is marked with the letter L or coloured RED.

If you have any questions concerning which proper power cord to use, please consult with the dealer from whom you have purchased the produc

Compliance Information for U.S.A.

This equipment has been tested and found to comply with the limits for a Class B digital device, pursuant to part 15 of the FCC Rules. These limits are designed to provide reasonable protection against harmful interference in a resi-dential installation. This equipment generates, uses, and can radiate radio frequency energy, and if not installed and used in accordance with the instructions, may cause harmful interference to radio communications. However, there is no guarantee that interference will not occur in a particular installation. If this equipment does cause harmful interference to radio or television reception, which can be determined by turning the equipment off and on, the user is encouraged to try to correct the interference by one or more of the following measures:

- Reorient or relocate the receiving antenna.
- Increase the separation between the equipment and receiver.
- Connect the equipment into an outlet on a circuit different from that to which the receiver is connected.
- Consult the dealer or an experienced radio/TV technician for help.

FCC Warning

To assure continued FCC compliance, the user must use grounded power supply cord and the provided shielded video interface cable with bonded ferrite cores. If a BNC cable is going to be used, use only a shielded BNC(5) cable. Also, any unauthorized changes or modifications not expressly approved by the party responsible for compliance could void the user's authority to operate this device.



ViewSonic®